

**OKI**

# Office Product Range Guide



# OKI Mono Printer Range Guide



## The OKI B412dn Mono Printer

A4

PCL

Auto Duplex Print

**B412dn (EURO) 45762002**  
**B412dn (2AC) 45858301**

### B412 with 2<sup>nd</sup> paper tray

- USB 2.0 and Gigabit Network
- Wireless Interface option
- Auto Feed 100 sheet MPT tray
- 250 sheet paper tray

- 530 sheet 2<sup>nd</sup> tray option (up to 880 sheets)



### Environmental Credentials

**Eco mode saves time and energy** by automatically adjusts print speed and fuser temperature to reduce warm-up time and power consumption to deliver 1 or 2 page print jobs faster than the time taken to run the unit at full speed  
**1.4Watt Deep Sleep** mode and super fast recovery time saves power without impacting on performance  
**Auto-Off** feature delivers big power savings over product life.



Powerful **667MHz** processor and **512MB** RAM deliver fast job processing



**3GB eMMC memory** stores secure print jobs, templates and fonts safely even if power is lost.



**Secure Print** function password protects sensitive documents from being printed in the general office.



Google Cloud Print Ready



### B412

- **Affordable, professional A4 mono printing**
- **Desktop design for 1 to 5 users**
- Print speed – 33ppm A4 mono
- Time to first print 5 seconds
- Ultra reliable 1200x1200dpi digital LED print quality
- Powerful 667MHz processor with 512MB RAM and 3GB eMMC memory
- PCL6(XL), PCL5e, IBM ProPrinter & Epson FX, XPS
- 12 types of 1 dimension & 1 type of 2 dimension (PDF417) barcodes
- Auto duplex is standard (60-120gsm)
- 100 sheet, auto feeding MPT tray, A6 to 1.3m banners (60-163gsm)
- 250 sheet universal tray from A6 to 14" legal paper (60-120gsm)
- Optional 530 sheet 2<sup>nd</sup> paper tray (60-120gsm)
- Hi-Speed USB 2.0 and 10/100/1000BaseTX interfaces
- Impressive 60,000 pages per month duty cycle (3,000 Average)
- Highly affordable 3,000 page and 7,000 page toner cartridges
- Compact design (HxWxD) 245 x 387 x 364mm (H = 383mm 2<sup>nd</sup> Tray)
- Environmental features include Eco mode to improves throughput and reduces energy consumption, 1.4W Deep Sleep mode, Auto power Off
- Quiet Mode reduces print speed to lower noise and energy levels
- Secure printing protects confidential documents

### Consumables

Product	Life	Order No.
<i>Starter Toners</i>	<i>2,000</i>	<i>n/a</i>
Black Toner	3,000	45807102
Black Toner	7,000	45807106
Black Drum	25,000	44574302

### Accessories

- **2<sup>nd</sup> paper tray (44575714)**  
For increased paper capacity or flexible feeding of multiple paper types (capacity 530 sheets)
- **Wireless LAN Module (45830202)**  
Make positioning and sharing easy with Wireless interfacing

## The OKI B432dn Mono Printer

A4

PCL/PS

Auto Duplex Print

**B432dn (EURO) 45762012**  
**B432dn (2AC) 45858302**

### B432 with 2<sup>nd</sup> paper tray

- USB 2.0 and Gigabit Network
- Wireless Interface option
- Auto Feed 100 sheet MPT tray
- 250 sheet paper tray

- 530 sheet 2<sup>nd</sup> tray option (up to 880 sheets)



Google Cloud Print Ready



### Environmental Credentials

**Eco mode saves time and energy** by automatically adjusts print speed and fuser temperature to reduce warm-up time and power consumption to deliver 1 or 2 page print jobs faster than the time taken to run the unit at full speed

**1.4Watt Deep Sleep** mode and super fast recovery time saves power without impacting on performance

**Auto-Off** feature delivers big power savings over product life.



Powerful **667MHz** processor and **512MB** RAM deliver fast job processing



**3GB eMMC memory** stores secure print jobs, templates and fonts safely even if power is lost.



**Secure Print** function password protects sensitive documents from being printed in the general office.

### B432

- **High performance A4 mono printing for demanding users**
- **Desktop design for 1 to 10 users**
- Print speed – 40ppm A4 mono
- Time to first print 4.5 seconds
- Ultra reliable 1200x1200dpi digital LED print quality
- Powerful 667MHz processor with 512MB RAM and 3GB eMMC memory
- PCL6, PCL5e, PostScript3, IBM ProPrinter & Epson FX
- 12 types of 1 dimension & 1 type of 2 dimension (PDF417) barcodes
- Auto duplex is standard (60-120gsm)
- 100 sheet, auto feeding MPT tray, A6 to 1.3m banners (60-163gsm)
- 250 sheet universal tray from A6 to 14" legal paper (60-120gsm)
- Optional 530 sheet 2<sup>nd</sup> paper tray (60-120gsm)
- Hi-Speed USB 2.0 and 10/100/1000BaseTX interfaces
- Impressive 80,000 pages per month duty cycle (5,000 Average)
- Highly affordable 3,000, 7,000 and 12,000 page toner cartridges
- Compact design (HxWxD) 245 x 387 x 364mm (H = 383mm 2<sup>nd</sup> Tray)
- Environmental features include Eco mode to improves throughput and reduces energy consumption, 1.4W Deep Sleep mode, Auto power Off
- Quiet Mode reduces print speed to lower noise and energy levels
- Secure printing protects confidential documents

### Consumables

Product	Life	Order No.
<i>Starter Toners</i>	<i>2,000</i>	<i>n/a</i>
Black Toner	3,000	45807102
Black Toner	7,000	45807106
Black Toner	12,000	45807111
Black Drum	25,000	44574302

### Accessories

- **2<sup>nd</sup> paper tray (44575714)**  
For increased paper capacity or flexible feeding of multiple paper types (capacity 530 sheets)
- **Wireless LAN Module (45830202)**  
Make positioning and sharing easy with Wireless interfacing

## The OKI B512dn Mono Printer

A4

PCL/PS

Auto Duplex Print

**B512dn (EURO) 45762022**  
**B512dn (2AC) 45858303**

### B512 with 2<sup>nd</sup> paper tray

- USB 2.0 and Gigabit Network
- Wireless Interface option
- Auto Feed 100 sheet MPT tray
- 530 sheet paper tray

- 530 sheet 2<sup>nd</sup> tray option (up to 1,160 sheets)



### Environmental Credentials

**Eco mode saves time and energy** by automatically adjusting print speed and fuser temperature to reduce warm-up time and power consumption to deliver 1 or 2 page print jobs faster than the time taken to run the unit at full speed  
**1.4Watt Deep Sleep** mode and super fast recovery time saves power without impacting on performance  
**Auto-Off** feature delivers big power savings over product life.



Powerful **667MHz** processor and **512MB** RAM deliver fast job processing



**3GB eMMC memory** stores secure print jobs, templates and fonts safely even if power is lost.



**Secure Print** function password protects sensitive documents from being printed in the general office.



Google Cloud Print Ready



### B512

- **High performance A4 mono printing for the workgroup**
- **Desktop design for 1 to 15 users**
- Print speed – 45ppm A4 mono
- Time to first print 4.5 seconds
- Ultra reliable 1200x1200dpi digital LED print quality
- Powerful 667MHz processor with 512MB RAM and 3GB eMMC memory
- PCL6, PCL5e, PostScript3, IBM ProPrinter & Epson FX
- 12 types of 1 dimension & 1 type of 2 dimension (PDF417) barcodes
- Auto duplex is standard (60-120gsm)
- 100 sheet, auto feeding MPT tray, A6 to 1.3m banners (60-163gsm)
- 530 sheet universal tray from A6 to 14" legal paper (60-120gsm)
- Optional 530 sheet 2<sup>nd</sup> paper tray (60-120gsm)
- Hi-Speed USB 2.0 and 10/100/1000BaseTX interfaces
- Impressive 100,000 pages per month duty cycle (5,500 Average)
- Highly affordable 3,000, 7,000 and 12,000 page toner cartridges
- Compact design (HxWxD) 286 x 387 x 364mm (H = 424mm 2<sup>nd</sup> Tray)
- Environmental features include Eco mode to improve throughput and reduce energy consumption, 1.4W Deep Sleep mode, Auto power Off
- Quiet Mode reduces print speed to lower noise and energy levels
- Secure printing protects confidential documents

### Consumables

Product	Life	Order No.
<i>Starter Toners</i>	<i>2,000</i>	<i>n/a</i>
Black Toner	3,000	45807102
Black Toner	7,000	45807106
Black Toner	12,000	45807111
Black Drum	25,000	44574302

### Accessories

- **2<sup>nd</sup> paper tray (44575714)**  
For increased paper capacity or flexible feeding of multiple paper types (capacity 530 sheets)
- **Wireless LAN Module (45830202)**  
Make positioning and sharing easy with Wireless interfacing

# The OKI B721 and B731 Mono Printers

A4 PCL/PS

# OKI

**B721dn (EURO) 45487002**  
**B721dn (2AC) 01334001**

**B731dnw (EURO) 45487102**  
**B731dnw (2AC) 01334101**

- As B721dn with:
- 52ppm
  - Wireless Network
  - High Capacity 36K Print Cartridge



## Example configurations



- 1,160 Sheet Capacity**  
with
- Additional 530 Sheet Tray
  - Castor Base



- 1,690 Sheet Capacity**  
with
- 2 x Additional 530 Sheet Tray
  - Castor Base



- 2,220 Sheet Capacity**  
with
- 3 x Additional 530 Sheet Tray
  - Castor Base



- 3,160 Sheet Capacity**  
with
- 1 x Additional 530 Sheet Tray
  - 2,000 Sheet LCF

## B721 & B731

### Enterprise class mono printers for enhanced efficiency

- **B721** 47ppm; **B731** 52ppm
- First page out time of less than 5 seconds
- Gigabit Ethernet
- Wireless networking - **B731 only**
- 800Mhz processor with 256MB (768MB Max) memory
- Optional 160GB Hard Disk Drive
- 1200 x 1200dpi resolution
- Standard duplex printing (220gsm)
- Standard paper capacity 630 sheets including 100 sheet MPT
- Optional 3 x 530 sheets additional trays
- Maximum 3,160 sheets paper capacity with 2,000 sheet large capacity feeder
- Media weight up to 253gsm from MPT and 220gsm from trays
- 500 sheet output tray capacity
- PCL and PS3 emulations
- Deep sleep mode
- Numeric keyboard to support PIN protected secure print
- Energy Star compliant
- High capacity 36K print cartridge - **B731 only**

## Consumables

Product	Life	Order No.
Starter Toner	10,000	n/a
Print Cartridge	18,000	45488802
Print Cartridge	36,000*	45439002
Maintenance kit	200,000	45435104

Notes: Toner yields are using ISO 19752

\* 36K toner is only for use in B731

## Accessories

- **Additional Paper Trays (45478902)**  
Adds up to three additional paper trays for improved paper flexibility and increased capacity - 530 sheets each tray
- **Castor Base (45478702)**  
Must be fitted for floor standing when using additional paper trays
- **Large Capacity Feeder (LCF) (45530102)**  
Adds additional 2,000 sheet capacity
- **DIMM Memory - 512MB (01182908)**  
Improve processing performance of large print files
- **Hard Disk Drives - 160GB (44622305)**  
For enhanced storage of secure and encrypted print jobs

## The OKI B840 Mono Printer

A3/A4

PCL/PS

### B840dn (EURO) 01308001

(Paper capacity up to 630 sheets)

As B840n with

- Automatic Duplex

As B840dn with

- 2<sup>nd</sup> Tray  
(Total Capacity 1,160 sheets)

With optional 3<sup>rd</sup> paper tray  
(Total paper capacity 1,690 sheets)



### B840

- An A4 printer with added versatility of A3 output
- Brings affordable A3 and A4 printing to the workgroup

- 40ppm A4, 22ppm A3 mono
- First page out time in as little as 5 seconds
- Network standard
- Duplex (105gsm) standard on B840dn and B840dtn
- 530 Sheet Tray & 100 sheet multipurpose tray (MPT).
- Maximum 1,690 sheets from 4 paper sources (when fitted with 2 x optional 530 sheet tray)
- Media weight up to 200gsm from MPT and 176gsm from all other trays
- PCL & PostScript 3 Emulation with 533MHz processor and 128MB memory (640MB Max)
- Deep Sleep Mode (<1.2W)
- 16GB SD card option for job storage and encrypted secure print
- B840dn & B840dtn Energy Star compliant.
- Heavy duty 100,000 pages per month duty cycle (average 20,000 pages)
- Standard 20,000 page print cartridge

### Consumables

Product	Life	Order No.
Starter Toner	6,000	n/a
Print Cartridge	20,000	44661802

Note: Toner yields are using ISO 19752

### Accessories

- **Auto Duplex Unit\* (44676203) \*Standard on B840dn/dtn**  
Double sided printing adds to professional presentation of documents answering environmental concerns and saving on costs
- **2<sup>nd</sup>\* & 3<sup>rd</sup> Paper Trays (44676103) \*Standard on B840dtn**  
Add an additional 1 or 2 paper trays for improved flexibility and increased capacity (530 sheets per tray)
- **Memory - 256MB (01182907) 512MB (01182908)**  
Enhances performance processing complex images or large print jobs
- **SDHC Memory Card – 16GB (01272701)**  
Enables Secure Print function.



## OKI Colour Printer Range Guide





# The OKI C332dn

A4 PCL/PS Auto Duplex

# OKI

C332dn (EURO) 46403102  
C332dn (2AC) 46553101

(Paper capacity up to 880 sheets)

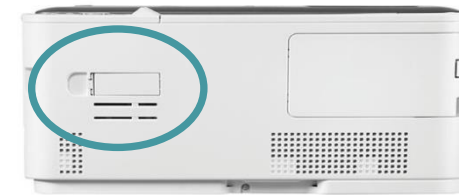

## C332dn

- Everything you need from a colour printer without the price tag
- Perfect for the micro business or small office

- 26ppm colour, 30ppm mono – Fastest in market
- Up to 880 sheets paper capacity with 2<sup>nd</sup> tray
- 1GB RAM memory, 667MHz processor
- Citrix XenApp 7.6 compatible
- AirPrint & Google Cloud Print 2.0
- Gigabit Ethernet
- Concurrent Wired & Wireless Connection
- Flat paper path gives unrivalled media flexibility with standard office papers A6, A5, A4 plus banners up to 1,320mm in length
- New simple Set up
- Firmware update through portal
- Video guidance on cons change
- Quiet mode for small offices
- Duty cycle:
  - 3k pages/ month recommended
  - 45K pages/ month maximum

## Consumables

Product	Life	Part No.
Starter Toners	1000	n/a
Cyan Toner	1,500	46508715
Cyan Toner	3,000	46508711
Magenta Toner	1,500	46508714
Magenta Toner	3,000	46508710
Yellow Toner	1,500	46508713
Yellow Toner	3,000	46508709
Black Toner	1,500	46508716
Black Toner	3,500	46508709
Drum Unit (M/C)	30k/20k	44968301
Fuser Unit	60,000	44472603
Transfer Belt	60,000	44472202

## Accessories

- 2<sup>nd</sup> Tray - (44472102)
- Cabinet - (01314101)
- Wireless LAN - (45830202)

# The OKI C532dn

A4 PCL/PS Auto Duplex

# OKI

C532dn (EURO) 46356102  
C532dn (2AC) 46552601

(Paper capacity up to 1,410 sheets)



## C532dn

### • Excellent Print quality & Solid Security

- 30/30ppm print speed – New engine!
- 1200x1200dpi print resolution
- 1,410 sheets with 2 optional trays
- 1GB RAM memory
- Citrix XenApp 7.6 compatible
- AirPrint & Google Cloud Print 2.0
- Gigabit Ethernet
- Wireless Direct
- Concurrent Wired and Wireless Connection
- Private Print
- Optional Card Release (Jan-2017)
- IPSec
- Simple Set up
- Firmware update through portal
- Video guidance on consumables change
- QR code to videos on consumables
- Shared Jobs on Device
- Duty cycle: 6k recommended/ 60k max

## Consumables

Product	Life	Part No.
<i>Starter Toners</i>	<i>2,000</i>	<i>n/a</i>
Cyan Toner	1,500	46490403
Cyan Toner	6,000	46490607
Magenta Toner	1,500	46490402
Magenta Toner	6,000	46490606
Yellow Toner	1,500	46490401
Yellow Toner	6,000	46490605
Black Toner	1,500	46490404
Black Toner	7,000	46490608
Drum Cyan	30,000	46484107
Drum Magenta	30,000	46484106
Drum Yellow	30,000	46484105
Drum Black	30,000	46484108
Fuser Unit	60,000	46358502
Transfer Belt	60,000	46394902

## Accessories

- **2nd Paper Tray (46361802)**  
Add up to 2 additional paper trays and increase paper capacity to 1,410 sheets
- **Cabinet (46567701)**
- **Wireless LAN (45830202)**
- **Card Reader Lock in Kit (46566001)**  
Space next to panel to neatly place card reader. Use this accessory to secure the card reader in place, so that no user can walk away with the reader. Place a sticker on top to indicate where to swipe the card.

\* Blue Angel certification from April 2017

# The OKI C542dn

A4 PCL/PS Auto Duplex

# OKI

C542dn (EURO) 46356132  
C542dn (2AC) 46552602

(Paper capacity up to 1,410 sheets)



## C542dn

- **sXP Connectivity to Pull Printing Fleet**
- **Everything as C532dn, and on top;**
- **7" Colour Touch Screen** for:
  - Quick and easy to customise
  - View Private Print files
  - View Shared Print files
  - Troubleshooting on screen
- **OKI Open Architecture sXP (smart eXtensible platform)**
  - Connectivity into pull printing fleet
  - Ability to run 3rd party software
  - Sendys Explorer Lite at no cost
- OKI FAQ through Mobile Print app

## Consumables

Product	Life	Part No.
<i>Starter Toners</i>	<i>2,000</i>	<i>n/a</i>
Cyan Toner	1,500	46490403
Cyan Toner	6,000	46490607
Magenta Toner	1,500	46490402
Magenta Toner	6,000	46490606
Yellow Toner	1,500	46490401
Yellow Toner	6,000	46490605
Black Toner	1,500	46490404
Black Toner	7,000	46490608
Drum Cyan	30,000	46484107
Drum Magenta	30,000	46484106
Drum Yellow	30,000	46484105
Drum Black	30,000	46484108
Fuser Unit	60,000	46358502
Transfer Belt	60,000	46394902

## Accessories

- **2nd Paper Tray (46361802)**  
Add up to 2 additional paper trays and increased paper capacity to 1,410 sheets
- **Cabinet (46567701)**
- **Wireless LAN (45830202)**
- **Card Reader Lock in Kit (46566001)**  
Space next to panel to neatly place card reader. Use this accessory to secure the card reader in place, so that so user can walk away with the reader. Place a sticker on top to indicate where to swipe the card.

\* Blue Angel certification from April 2017

# The OKI C612

A4 PCL/PS

# OKI

**C612n (EURO) 46406003**  
**C612n (2AC) 46551001**

Equipped as standard with

- Paper capacity 400 sheets
- 2,000 page starter toners



**C612dn (EURO) 46551002**  
**C612dn (2AC) 46551003**

With optional  
 2<sup>nd</sup> Paper Tray  
 (Total 930 sheets)



With optional 3<sup>rd</sup> Paper Tray  
 (Total 1,460 sheets)



## C612n

### • Excellent Print quality for in-house colour printing

- Print Speed 34ppm colour, 36ppm mono
- ProQ2400 Multi-level technology with High Definition Toner
- Flat paper path gives unrivalled media flexibility with standard office papers A6, A5, A4 etc. and banners up to 1.2metre length
- 1,460 sheets (Max) with optional 2<sup>nd</sup>/3<sup>rd</sup> tray (530 pages, 64 to 220gsm)
- Google Cloud Print 2.0
- Gigabit Ethernet
- Wireless Direct
- Concurrent Wired and Wireless connection
- Citrix XenApp 7.6 compatible
- Private Print
- Optional Card Release (Feb-17)
- IPsec
- Firmware update through portal
- Shared jobs on device
- Duty cycle: 5k recommended/ 75k max

## Consumables

Product	Life	Order No.
Cyan Toner	6,000	46507507
Magenta Toner	6,000	46507506
Yellow Toner	6,000	46507505
Black Toner	8,000	46507508
Cyan Drum	30,000	46507307
Magenta Drum	30,000	46507306
Yellow Drum	30,000	46507605
Black Drum	30,000	46507308
Fuser Unit	60,000	44289103
Transfer Belt	60,000	45381102

## Accessories

- **Auto Duplex Unit\* (01272601) \*Standard on C612dn**  
 Double sided printing adds to professional presentation of documents answering environmental concerns and saving on costs
- **2<sup>nd</sup> & 3<sup>rd</sup> Paper Trays (44274502)**  
 Add an additional 1 or 2 paper trays for improved flexibility and increased capacity (530 sheets per tray)
- **Cabinet (01219302)**
- **Memory - 256MB (01182907) 512MB (01182908)**
- **SDHC Memory Card – 16GB (01272701)**  
 Fonts / forms storage, advanced printing security and enhanced colour matching. **Note** 32GB supported but not supplied by OKI
- **Wireless LAN (45830202)**
- **IC Card holder (46539501)**

# The OKI C712

A4 PCL/PS

# OKI

**C712n (EURO) 46406103**  
**C712n (2AC) 46551101**

**C712dn (EURO) 46551102**  
**C712dn (2AC) 46551103**

Equipped as standard with

- Paper capacity 630 sheets
- 4,000 page starter toners

With optional  
 2<sup>nd</sup> Paper Tray  
 (Total 1,160 sheets)

With optional 3<sup>rd</sup> Paper Tray  
 (Total 1,690 sheets)



## C712n

- **Superior performance for Enterprise Workgroups**
- **Fast, efficient colour with a low cost of ownership**

- Print Speed 34ppm colour, 36ppm mono
- ProQ2400 Multi-level technology with High Definition Toner
- Flat paper path gives unrivalled media flexibility with standard office papers A6, A5, A4 etc. and banners up to 1.2metre length
- Google Cloud Print 2.0
- Gigabit Ethernet
- Wireless Direct
- Concurrent Wired and Wireless connection
- Citrix XenApp 7.6 compatible
- Private Print
- Optional Card Release (Feb-17)
- IPsec
- Firmware update through portal
- Shared jobs on device
- Duty cycle: 6k recommended/ 100k max

## Consumables

Product	Life	Order No.
Cyan Toner	11,500	46507615
Magenta Toner	11,500	46507614
Yellow Toner	11,500	46507613
Black Toner	11,000	46507616
Cyan Drum	30,000	46507415
Magenta Drum	30,000	46507414
Yellow Drum	30,000	46507413
Black Drum	30,000	46507416
Fuser Unit	60,000	44289103
Transfer Belt	60,000	45381102

## Accessories

- **Auto Duplex Unit\* (01272601) \*Standard on C712dn**  
 Double sided printing adds to professional presentation of documents answering environmental concerns and saving on costs
- **2<sup>nd</sup> & 3<sup>rd</sup> Paper Trays (44274502)**  
 Add an additional 1 or 2 paper trays for improved flexibility and increased capacity (530 sheets per tray)
- **Cabinet (01219302)**
- **Memory - 256MB (01182907) 512MB (01182908)**
- **SDHC Memory Card – 16GB (01272701)**  
 Fonts / forms storage, advanced printing security and enhanced colour matching. **Note** 32GB supported but not supplied by OKI
- **Wireless LAN (45830202)**
- **IC Card holder (46539501)**

# The OKI C823

A3/A4

PCL

# OKI

**C823n (EURO) 46471514**  
**C823n (2AC) 46550701**

(Paper capacity up to 400 sheets)



**C823dn (EURO) 46550702**  
**C823dn (2AC) 46550703**

C823n/dn with optional

- 2<sup>nd</sup> Paper Tray  
 (Total 930 sheets)



## C823n

- **Ultra compact A3 printer for the small office and workgroup**
- **Brilliant colour output on a wide range of sizes and weights of media**

- Print Speed 23ppm colour (13ppm - A3), 23ppm mono (13ppm - A3)
- Warm up from power save 27secs & First print time 14sec colour & mono
- Resolution ProQ2400 Multi-level, 1200 x 600, 600 x 600dpi
- Flat paper path gives unrivalled media flexibility with standard office papers A6, A5, A3 and banners up to 1.32 metre length
- 930 sheets (Max) with optional 2<sup>nd</sup> tray (530 pages, 64 to 176gsm)
- Google Cloud Print 2.0
- Gigabit Ethernet
- Wireless Direct
- Concurrent Wired and Wireless connection
- Citrix XenApp 7.6 compatible
- Private Print
- Optional Card Release (Feb-17)
- Shared jobs on device
- Firmware update through portal
- Duty cycle: 5k recommended/ 75k max

## Consumables

Product	Life	Order No.
Starter Toner	2,500	N/A
Cyan Toner	7,000	46471103
Magenta Toner	7,000	46471102
Yellow Toner	7,000	46471101
Black Toner	7,000	46471104
Cyan Drum	30,000	46438003
Magenta Drum	30,000	46438002
Yellow Drum	30,000	46438001
Black Drum	30,000	46438004
Fuser Unit	100,000	44848805
Transfer Belt	80,000	44846204

## Accessories

- **Auto Duplex Unit (44717603) Option for C822n only**  
 Double sided printing adds to professional presentation of documents, answering environmental concerns and saving on costs
- **2<sup>nd</sup> Paper Tray (45887302)**  
 Add an additional 530 sheet paper tray for improved media flexibility and increased capacity
- **Memory - 256MB (01182907), 512MB (01182908)**  
 Enhances performance when processing complex images & jobs
- **16GB SDHC with mounting kit (44848903)**  
 Store print, secure print and encrypted secure printing
- **Cabinet (01321101)**
- **Wireless LAN (45830202)**
- **Banner Tray - NEW (45015702)**  
 Takes up to 10 sheets of 1.2m long banners, max 128gsm

# The OKI C833

A3/A4

PCL/PS

# OKI

**C833n (EURO) 44705904**  
**C833n (2AC) 01318801**

(Paper capacity up to 400 sheets)



**C833dn (EURO) 01328602**  
**C833dn (2AC) 01328603**

C833n/dn with optional  
 • 2<sup>nd</sup> Paper Tray  
 (Total 930 sheets)



C833dn with  
 • 2<sup>nd</sup> & 3<sup>rd</sup> Paper Tray



As C833dn with optional  
 • 2<sup>nd</sup>, 3<sup>rd</sup> and 4<sup>th</sup> additional trays



## C833n

- Ultra compact A3 colour printer for small and medium workgroups
- Flexible paper capacity for printing on a wide range of media

- Print Speed 35ppm colour (20ppm - A3), 35ppm mono (20ppm - A3)
- Warm up from power save 27secs & First print time 9.5sec colour & mono
- Resolution ProQ2400 Multi-level, 1200 x 600, 600 x 600dpi
- Flat paper path gives unrivalled media flexibility with standard office papers A6, A5, A3 and banners up to 1.32 metre length
- 2,005 sheets (Max) with optional trays
- Google Cloud Print 2.0
- Gigabit Ethernet
- Wireless Direct
- Concurrent Wired and Wireless connection
- Citrix XenApp 7.6 compatible
- Private Print
- Optional Card Release (Feb-17)
- Shared jobs on device
- Firmware update through portal
- Duty cycle: 5k recommended/ 75k max

## Consumables

Product	Life	Order No.
Starter Toner	2,500	N/A
Cyan Toner	10,000	46443103
Magenta Toner	10,000	46443102
Yellow Toner	10,000	46443101
Black Toner	10,000	46443104
Cyan Drum	30,000	46438003
Magenta Drum	30,000	46438002
Yellow Drum	30,000	46438001
Black Drum	30,000	46438004
Fuser Unit	100,000	44848805
Transfer Belt	80,000	44846204

## Accessories

- **Auto Duplex Unit (44717603) Option for C833n only**
- **2<sup>nd</sup>, 3<sup>rd</sup> and 4<sup>th</sup> Paper Trays (45887302)**  
 Add additional paper trays for improved media flexibility and increased capacity – additional 530 sheets per tray
- **Memory - 256MB (01182907), 512MB (01182908)**  
 Enhances performance when processing complex images & jobs
- **16GB SDHC with mounting kit (44848903)**  
 Store print, secure print and encrypted secure printing
- **Pedestal (44853983) Mandatory with 3 additional trays**
- **Cabinet (01321101)**  
 For safe positioning and paper and consumables storage
- **Wireless LAN (45830202)**
- **Banner Tray – NEW (45015702)**  
 Takes up to 10 sheets of 1.2m long banners, max 128gsm

# The OKI C843

A3/A4

PCL/PS

# OKI

**C843dn (EURO) 01318901**  
**C843dn (2AC) 01318903**

- Equipped as standard with
- Auto Duplex
  - Network Interface
  - Paper capacity 400 sheets



- C843dn with optional
- 2<sup>nd</sup> Paper Tray (Total 930 sheets)



- C843dn with
- 2<sup>nd</sup> & 3<sup>rd</sup> tray



- As C843dn with optional
- 2<sup>nd</sup>, 3<sup>rd</sup> and 4<sup>th</sup> additional trays with pedestal (Total 2,005 sheets)



## C843n

- **Ultra compact A3 colour printer for design and creative professionals**
- **1200 x 1200dpi output for crisper text and finer gradations**

- Print Speed 35ppm colour (20ppm - A3), 35ppm mono (20ppm - A3)
- Warm up from power save 27secs & First print time 9.5sec colour & mono
- PCL6, PCL5c, PostScript 3, emulations
- Resolution 1200 x 1200, 600 x 600dpi
- Flat paper path gives unrivalled media flexibility with standard office papers A6, A5, A3 and banners up to 1.32 metre length
- 2,005 sheets (Max) with optional trays
- Google Cloud Print 2.0
- Gigabit Ethernet
- Wireless Direct
- Concurrent Wired and Wireless connection
- Citrix XenApp 7.6 compatible
- Private Print
- Optional Card Release (Feb-17)
- Shared jobs on device
- Firmware update through portal
- Duty cycle: 5k recommended/ 75k max

## Consumables

Product	Life	Order No.
Starter Toner	2,500	N/A
Cyan Toner	10,000	46443103
Magenta Toner	10,000	46443102
Yellow Toner	10,000	46443101
Black Toner	10,000	46443104
Cyan Drum	30,000	46438003
Magenta Drum	30,000	46438002
Yellow Drum	30,000	46438001
Black Drum	30,000	46438004
Fuser Unit	100,000	44848805
Transfer Belt	80,000	44846204

## Accessories

- **2<sup>nd</sup>, 3<sup>rd</sup> and 4<sup>th</sup> Paper Trays (45887302)**  
Add additional paper trays for improved media flexibility and increased capacity – additional 530 sheets per tray
- **Memory - 256MB (01182907), 512MB (01182908)**  
Enhances performance when processing complex images & jobs
- **16GB SDHC with mounting kit (44848903)**  
Store print, secure print and encrypted secure printing
- **Pedestal (44853983) *Mandatory with 3 additional trays***
- **Cabinet (01321101)**  
For safe positioning and paper and consumables storage
- **Wireless LAN (45830202)**
- **Banner Tray – NEW (45015702)**  
Takes up to 10 sheets of 1.2m long banners, max 128gsm



# The OKI C911

A3/A4

PCL/PS

# OKI

## C911dn (45530406)

C911dn (paper capacity up to 830 sheets)



C911dn with 2<sup>nd</sup> tray (total paper capacity up to 1,360 sheets)



C911dn with High Capacity Feeder (total paper capacity up to 1,360 sheets)



## C911dn - Why to buy?

- **A3 colour printer for professional quality output, faster print speeds and unrivalled media flexibility**
- The C911dn offers outstanding print quality for general office use and occasional graphics arts printing
- Print speed 50ppm colour/mono (28ppm - A3 colour / mono)
- First print time 8 seconds colour & 8 seconds mono
- PCL6, PCL5c, Adobe PostScript 3, Direct PDF (v1.7)
- Superb print resolution of 1200 x 1200
- Flat paper path gives unrivalled media flexibility with standard office papers A6, A5, A3, A3+ and optional banner tray for printing banners up to 1.321 metres in length
- Faster job processing with 1.2GHz processor, 2GB memory and optional 160GB HDD
- 530 sheets Paper Tray and 300 sheet Multi-Purpose Tray (64 to 320gsm)
- 2,950 sheets (Max) with optional HCF and 2<sup>nd</sup> Tray (64 to 320gsm)
- Power consumption 1600w Max, <34w Power Save, Deep Sleep <4w
- Powerful 300,000 pages per month duty cycle
- Dimensions (H x W x D) 640 x 699 x 625mm
- Three year on-site warranty on registration within 30 days.

## Consumables

Product	Life	Order No.
Starter Toner	10,000	N/A
Cyan Toner	24,000	45536415
Magenta Toner	24,000	45536414
Yellow Toner	24,000	45536413
Black Toner	24,000	45536416
Cyan Drum	40,000	45103715
Magenta Drum	40,000	45103714
Yellow Drum	40,000	45103713
Black Drum	40,000	45103716
Fuser Unit	150,000	45531113
Transfer Belt	150,000	45531213
Waste Toner	40,000	45531503

## Accessories

- **2<sup>nd</sup>, 3<sup>rd</sup> Paper Trays (45530703)**  
Add additional paper trays for improved media flexibility and increased capacity – additional 530 sheets per tray
- **2<sup>nd</sup>, 3<sup>rd</sup> Paper Trays with castor wheels (45530903)**  
Add additional paper trays for improved media flexibility and increased capacity – additional 530 sheets per tray for floor standing placement.
- **High Capacity Feeder (45530803)**  
1,590 sheet capacity paper tray
- **160GB Hard Disk Drive (44622302)**  
Store print, secure print and encrypted secure printing
- **Cabinet (45980001)**  
For storing spare printer consumables
- **Banner Tray (45531003)**  
Print banners up to 1.321 metres in length

## OKI MFP Range Guide



# The OKI MB472dnw

A4

COPY

PCL

33.6Kbps Fax

SCAN

Auto Duplex Print/Copy/Scan/Fax

# OKI

**MB472 (EURO) 45762102**  
**MB472 (2AC) 45858401**

**MB472 with 2<sup>nd</sup> paper tray**

- USB2.0 and Gigabit Network
- Wireless Interface
- Auto Feed 100 sheet MPT tray
- 250 sheet paper tray

- 530 sheet 2<sup>nd</sup> tray option (up to 880 sheets)



Google Cloud Print Ready



Dedicated Copy, Scan, Print and Fax buttons make life easy.

An intuitive easy-to-use control panel, which includes a large user adjustable graphical LCD display, guides the user quickly through each task.

**Default Copy mode for walk up copying.**



**Job Macro** button allows users to record and recall settings for common tasks saving time and making life easy.

One Touch (OT) keys and speed dials makes sending faxes easy and efficient.

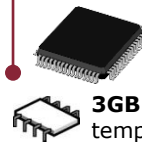

Powerful **667MHz** processor and **512MB** RAM deliver fast job processing



**3GB eMMC** memory stores secure print jobs, templates and fonts safely even if power is lost.

Separate Colour and Mono scan buttons. **Colour** button only, active for scanning.

A QWERTY keyboard makes searching and the typing of email addresses straightforward.

**Power Save** button instantly switches the machine into its energy saving mode. **Deep Sleep** mode (<3w) and **Auto-Off** feature delivers big power savings over product life.



**Encrypted Secure Print** function password protects sensitive documents in the general office. **Encrypted PDF** adds additional security.



## MB472 Print – Copy – Scan – Fax

- **Affordable, professional wireless A4 multifunction printer**
- **For the cost conscious user or small workgroup of 1 to 5 users**

- Print/Copy speed 33ppm and a time to first print of 5 seconds
- Easy to use operator panel with multi-tasking dual access as standard
- Flatbed scanner and 50 sheet RADF for duplex scanning and copying

### Print

- PCL6/PCL5c emulations and superb 1200x1200dpi digital LED print quality
- An auto sensing/feeding Multipurpose tray and flat paper path gives truly versatile media handling printing banners up to 1,321mm and 163gsm
- Gigabit Ethernet and Wireless networking make sharing easy

### Copy

- 600 x 600dpi & superb grey scale definition for authentic image reproduction
- First copy out: 10 seconds, ID copy function, zoom 25-400%, max 99 copies

### Scan

- Scan to E-Mail (Embedded LDAP), FTP, CIFS, TWAIN (inc MAC) & Network
- Colour 600 x 600dpi (Optical). Scan to Secure/HC PDF, M-TIFF, JPEG & XPS

### Fax

- Super G3 33.6kbps (2sec's) modem, Sender ID, secure fax & junk fax block
- 16 one touch and 100 speed dials, 20 group dials. 200 page flash memory

## Consumables

Product	Life	Part No.
Starter Toner	2,000	n/a
3k Toner	3,000	45807102
7k Toner	7,000	45807106
Drum Unit	25,000	44574302

## Accessories

- **530 Sheet 2<sup>nd</sup> paper tray (44575714)**

For increased paper capacity or flexible feeding of multiple paper types

# The OKI MB492dn

A4

COPY

PCL/PS

33.6Kbps Fax

SCAN

Auto Duplex Print/Copy/Scan/Fax

# OKI

**MB492 (EURO) 45762112**  
**MB492 (2AC) 45858402**

**MB492 with 2<sup>nd</sup> paper tray**

- USB2.0 and Gigabit Network
- Auto Feed 100 sheet MPT tray
- 250 sheet paper tray

- 530 sheet 2<sup>nd</sup> tray option (up to 880 sheets)



Google Cloud Print Ready



**Job Macro** button allows users to record and recall settings for common tasks saving time and making life easy.

Dedicated Copy, Scan, Print and Fax buttons make life easy.

On Screen **QWERTY** keyboard makes searching and the typing of email addresses easy.



Powerful **667MHz** processor and **512MB** RAM for very fast job processing



**3GB eMMC memory** stores secure print jobs, templates and fonts safely even if power is lost.



**Encrypted Secure Print** function password protects sensitive documents from being printed in the general office. **Encrypted PDF** adds additional security.

Customisable **7" LCD colour touch screen** display, guides the user quickly through each task.

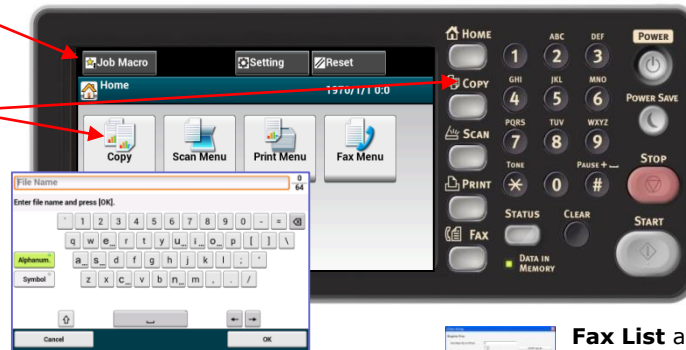

**Power Save** button instantly switches the machine into its energy saving mode. **Deep Sleep** mode (<3w) and **Auto-Off** feature delivers big power savings over product life.



**Fax List** allows users to view faxes in the display before choosing to print or delete.

**Fax Forward** allows users to automatically forward faxes to their email address for remote working.

## MB492 Print – Copy – Scan – Fax

- **High performance A4 mono multifunction printer demanding users**
- **For the demanding user or small workgroup of 1 to 15 users**

- Print/Copy speed 40ppm and a time to first print of 4.5 seconds
- Simple to use and fully customisable 7" LCD Colour touch screen display
- Flatbed scanner and 50 sheet RADF for duplex scanning and copying

### Print

- PCL6/PCL5c emulations and superb 1200x1200dpi digital LED print quality
- An auto sensing/feeding Multipurpose tray and flat paper path gives truly versatile media handling printing banners up to 1,321mm and 220gsm
- Gigabit Ethernet networking make sharing easy

### Copy

- 600 x 600dpi & superb grey scale definition for authentic image reproduction
- First copy out: 10 seconds, ID copy function, zoom 25-400%, max 99 copies

### Scan

- Scan to E-Mail (Embedded LDAP), FTP, CIFS, TWAIN (inc MAC) & Network
- Colour 600 x 600dpi (Optical). Scan to Secure/HC PDF, M-TIFF, JPEG & XPS

### Fax

- Super G3 33.6kbps (2sec's) modem , Sender ID, secure fax & junk fax block
- 16 one touch and 100 speed dials, 20 group dials. 200 page flash memory

## Consumables

Product	Life	Part No.
Starter Toner	2,000	n/a
3k Toner	3,000	45807102
7k Toner	7,000	45807106
12k Toner	12,000	45807111
Drum Unit	25,000	44574302

## Accessories

- **530 Sheet 2<sup>nd</sup> paper tray (44575709)**  
For increased paper capacity or flexible feeding of multiple paper types

# The OKI MB562dnw

A4

COPY

PCL/PS

33.6Kbps Fax

SCAN

Auto Duplex Print/Copy/Scan/Fax

# OKI

**MB562 (EURO) 45762122**  
**MB562 (2AC) 45858403**

**MB562 with 2<sup>nd</sup> paper tray**

- USB2.0 and Gigabit Network
- Wireless Interface
- Auto Feed 100 sheet MPT tray
- 530 sheet paper tray

- 530 sheet 2<sup>nd</sup> tray option (up to 1160 sheets)



Google Cloud Print Ready



**Job Macro** button allows users to record and recall settings for common tasks saving time and making life easy.

Dedicated Copy, Scan, Print and Fax buttons make life easy.

On Screen **QWERTY** keyboard makes searching and the typing of email addresses easy.



Powerful **667MHz** processor and **512MB** RAM for very fast job processing



**3GB eMMC memory** stores secure print jobs, templates and fonts safely even if power is lost.



**Encrypted Secure Print** function password protects sensitive documents from being printed in the general office. **Encrypted PDF** adds additional security.

Customisable **7" LCD colour touch screen** display, guides the user quickly through each task.

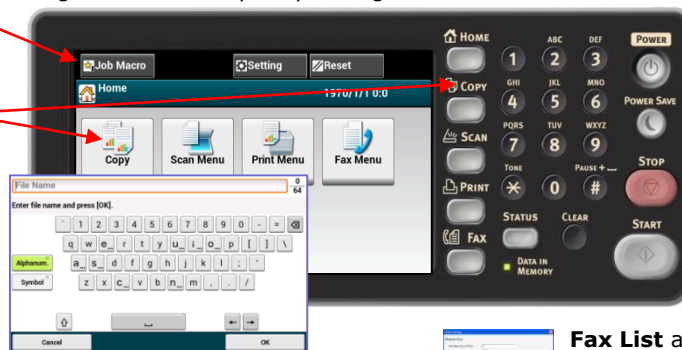

**Power Save** button instantly switches the machine into its energy saving mode. **Deep Sleep** mode (<3w) and **Auto-Off** feature delivers big power savings over product life.



**Fax List** allows users to view faxes in the display before choosing to print or delete.

**Fax Forward** allows users to automatically forward faxes to their email address for remote working.

## MB562 Print – Copy – Scan – Fax

- **High performance A4 mono multifunction printer for the workgroup**
- **For the demanding user or small workgroup of 1 to 25 users**

- Print/Copy speed 45ppm and a time to first print of 4.5 seconds
- Simple to use and fully customisable 7" LCD Colour touch screen display
- Flatbed scanner and 50 sheet RADF for duplex scanning and copying

### Print

- PCL6/PCL5c emulations and superb 1200x1200dpi digital LED print quality
- An auto sensing/feeding Multipurpose tray and flat paper path gives truly versatile media handling printing banners up to 1,321mm and 220gsm
- Gigabit Ethernet and Wireless networking make sharing easy

### Copy

- 600 x 600dpi & superb grey scale definition for authentic image reproduction
- First copy out: 10 seconds, ID copy function, zoom 25-400%, max 99 copies

### Scan

- Scan to E-Mail (Embedded LDAP), FTP, CIFS, TWAIN (inc MAC) & Network
- Colour 600 x 600dpi (Optical). Scan to Secure/HC PDF, M-TIFF, JPEG & XPS

### Fax

- Super G3 33.6kbps (2sec's) modem, Sender ID, secure fax & junk fax block
- 16 one touch and 100 speed dials, 20 group dials. 200 page flash memory

## Consumables

Product	Life	Part No.
Starter Toner	2,000	n/a
3k Toner	3,000	45807102
7k Toner	7,000	45807106
12k Toner	12,000	45807111
Drum Unit	25,000	44574302

## Accessories

- **530 Sheet 2<sup>nd</sup> paper tray (44575709)**  
For increased paper capacity or flexible feeding of multiple paper types

# The OKI MB760

A4 COPY PCL/PS SCAN Auto Duplex Print/Copy/Scan 33.6Kbps Fax

# OKI

MB760dnfax (EURO) 45387104  
 MB760dnfax (2AC) 01334401



### Example configurations



With 2<sup>nd</sup>/3<sup>rd</sup> trays and Castor Base

- 1,690 sheets



With HCF

- 2,630 sheets



With 2<sup>nd</sup>/3<sup>rd</sup>/4<sup>th</sup> trays and Castor Base

- 2,220 sheets



With 2<sup>nd</sup> tray & HCF

- 3,160 sheets



## MB760 Print – Copy – Scan – Fax (dnfax version)

### Standard 'dnfax' configuration

- Mono printing, copying and faxing plus colour scanning
- 9" (23cm) colour display
- 47ppm mono copy and print speeds
- Scan to email (LDAP), network PC and USB memory
- 100 sheet RADF scanner for double sided copying and scanning
- Standard duplex printing (220gsm)
- Standard paper capacity 630 sheets including 100 sheet multipurpose tray
- Optional 530 sheets additional trays or 2,000 sheet large capacity feeder
- Max paper capacity 3,160 sheets
- Media weight up to 250gsm from MPT and 220gsm from all other trays
- PCL and PS3 emulations
- 2GB memory with 1.2Ghz Processor for fast print processing
- Deep sleep mode (<2.0W)
- Active Directory for user access control
- sXP - Open architecture for support of third party software solutions
- Secure print, Password protected PDF, IPsec, IC card release
- Standard capacity 18K black print cartridge
- Integrated convenient stapler
- 200,000 page monthly duty cycle (20K AMPV)
- Energy Star compliant

## Consumables

Product	Life	Part No.
Starter Toner	10,000	n/a
Print Cartridge	18,000	45488802
Maintenance Kit	200,000	45435104
Staples STD	3,000	45513301

**Note:**  
 Toner Yields are based on ISO 19752

## Accessories

- **Additional Paper Trays (45479002)**  
 Adds up to three additional paper trays for improved paper flexibility and increased capacity - 530 sheets each tray.  
**Note: Castor Base (45466602) must be fitted with trays**
- **Large Capacity Feeder (LCF) (45393302)**  
 Adds additional 2,000 sheet capacity
- **Data Overwrite Enabler (45518101)** to auto-erase copy, print and scan data;  
**IPsec Enabler (45518401)** to add IPsec encryption technology;  
**Meta Scan Enabler (45518201)** to enable the addition of extra data to scanned images
- **IC Card Readers complete with bracket: Mifare Type (45518601); HID Type (45518501)**  
 Card readers for user authentication
- **Wireless Networking: Wireless kit(45517901); Antenna (45518001)**  
 Add wireless networking – **Note:** Requires Engineer Installation

# The OKI MB770

A4

COPY

PCL/PS

SCAN

Auto Duplex Print/Copy/Scan

33.6Kbps Fax

# OKI

**MB770dn (EURO) 45387204**  
**MB770dn (2AC) 01334402**

**MB770dnfax (MULTI) 45387404**  
**MB770dnfax (2AC) 01334404**

**MB770dnfax (EURO) 45387304**  
**MB770dnfax (2AC) 01334403**

### Includes Internal Finisher

- 500 Sheet Capacity
- 50 Sheet Staple

### Example configurations



**Integrated Convenience Stapler**



**Internal Finisher Offset sort and staple (50 sheets)**



**With 2<sup>nd</sup>/3<sup>rd</sup> trays and Castor Base**  
 • 1,690 sheets



**With HCF**  
 • 2,630 sheets



**With 2<sup>nd</sup>/3<sup>rd</sup>/4<sup>th</sup> trays and Castor Base**  
 • 2,220 sheets



**With 2<sup>nd</sup> tray & HCF**  
 • 3,160 sheets

## MB770 Print – Copy – Scan – Fax (dnfax and dnfax versions)

### Choice of 'dn', 'dnfax' and 'dnfax' (finisher) configuration

- Mono printing, copying and faxing plus colour scanning
- 9" (23cm) colour display
- 52ppm mono copy and print speeds
- Scan to email (LDAP), network PC and USB memory
- 100 sheet RADF scanner for double sided copying and scanning
- Standard duplex printing (220gsm)
- Standard paper capacity 630 sheets including 100 sheet multipurpose tray
- Optional 530 sheets additional trays or 2,000 sheet large capacity feeder
- Max paper capacity 3,160 sheets
- Media weight up to 250gsm from MPT and 220gsm from all other trays
- PCL and PS3 emulations
- 2GB memory with 1.2Ghz Processor for fast print processing
- Deep sleep mode (<2.0W)
- Active Directory for user access control
- sXP - Open architecture for support of third party software solutions
- Secure print, Password protected PDF, IPsec, IC card release
- High capacity 36K black print cartridge
- Integrated convenient stapler & internal finisher (dnfax version)
- 200,000 page monthly duty cycle (30K AMPV)
- Energy Star compliant

Product	Life	Part No.
Starter Toner	10,000	n/a
Print Cartridge	18,000	45488802
Print Cartridge	36,000	45439002
Maintenance Kit	200,000	45435104
Staples STD	3,000	45513301
Staples Finisher	15,000	42937603

**Note:**  
 Toner Yields are based on ISO 19752

## Consumables

## Accessories

- **Additional Paper Trays (45479002)**  
 Adds up to three additional paper trays for improved paper flexibility and increased capacity - 530 sheets each tray.  
**Note: Castor Base (45466602) must be fitted with trays**
- **Large Capacity Feeder (LCF) (45393302)**  
 Adds additional 2,000 sheet capacity
- **Data Overwrite Enabler (45518101)** to auto-erase copy, print and scan data;  
**IPsec Enabler (45518401)** to add IPsec encryption technology;  
**Meta Scan Enabler (45518201)** to enable the addition of extra data to scanned images
- **IC Card Readers complete with bracket: Mifare Type (45518601); HID Type (45518501)**  
 Card readers for user authentication
- **Wireless Networking: Wireless kit(45517901); Antenna (45518001)**  
 Add wireless networking – **Note:** Requires Engineer Installation

# The OKI MB700 Series – Accessories Overview

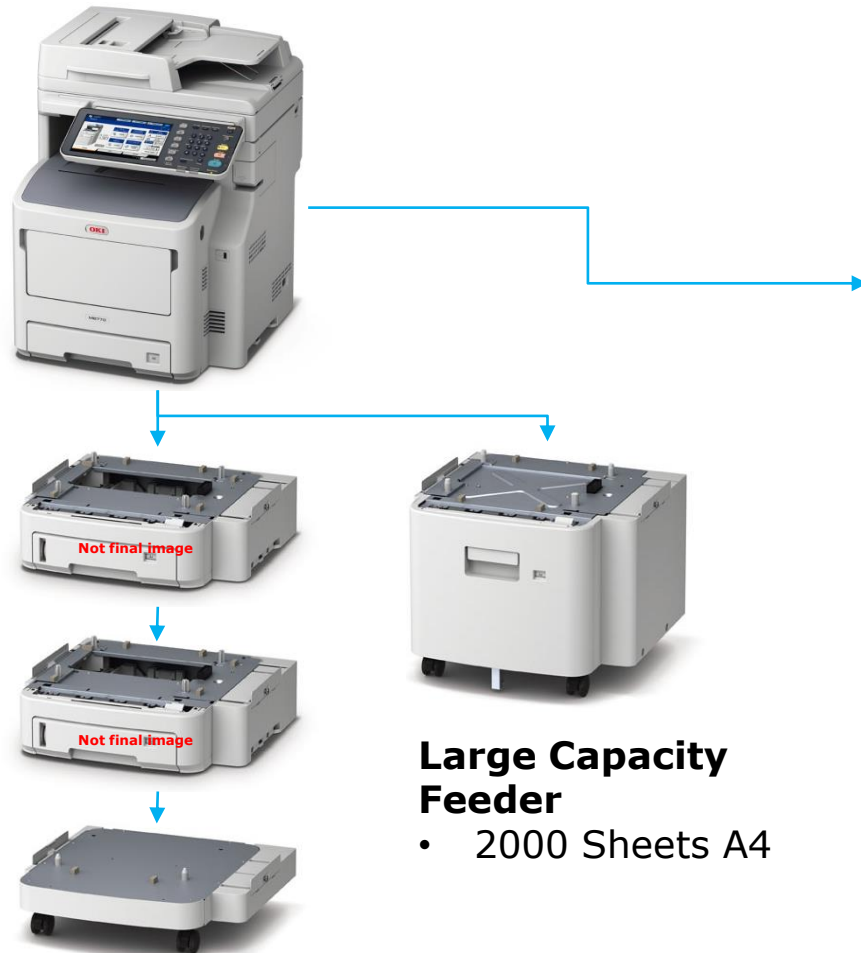

**Large Capacity Feeder**

- 2000 Sheets A4

**Additional Trays**

- 530 Sheets A4
- Castor Base

**Note:** It is recommended that only the base model (without additional trays) is used on a desktop. When used in floor standing configuration, the castor base must be fitted. The castor base includes stability feet (not shown) which must also be fitted.



## Data Overwrite Enabler

Automatically overwrites data.  
Data is overwritten immediately following the completion of the copy, print or scan job.



## IPsec Enabler

This optional protocol prevents communication contents from being viewed or tampered with in the communication path when using an application that does not support encryption.

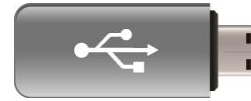

## Meta Scan Enabler

Meta Scan – This is to enable the function of adding meta data to the scanning function. This allows a Meta Scan to control the scan workflow in existing business systems using meta data relating to each document.



## IC Card Readers

- HID
- Mifare

Card Readers automatically log users into the device when a valid card is in the proximity of the reader.



## Wireless Network

Add wireless networking  
**Note:** Requires both the Wireless kit (45517901) & Antenna (45518001) and requires Engineer Installation

**Note:** Other types of access control devices may be able to be used. Please contact OKI for details of compatible devices or to find more information



# The OKI MC363dn

A4

COPY

PCL/PS

33.6Kbps Fax

SCAN

Auto Duplex Print/Copy/Scan

# OKI

## MC363dn (EURO) 46403502

- Gigabit Ethernet, USB 2.0 and Optional Wireless
- Auto Duplex (Up to 350 sheets)



## MC363 with 2<sup>nd</sup> paper tray

(Up to 880 sheets)



Print from and Scan to smartphones and tablets with **OKI Mobile Print App**



**USB direct Print** from and Scan to

Insert **Optional Wireless LAN** module at the side of the product. **Wireless Direct** offers safe simultaneous connection of wired and wireless networking



Flexible media handling allows printing up to **1.3m long banners**

## MC363dn Print – Copy – Scan – Fax

**Exceptional multifunction A4 colour printer offering outstanding value for money for SMBs**

- Print/Copy speed 26ppm colour, 30ppm mono
- Duplex copy/scan/print
- 1GB RAM memory, 667MHz processor
- Citrix XenApp 7.6 compatible
- Flat paper path gives unrivaled media flexibility with standard office papers A4, A5, A6 etc. and banners up to 1,320mm long

### Improved Connectivity

- AirPrint & Google Cloud Print 2.0
- Gigabit Ethernet
- Wireless Direct – Concurrent Wired and Wireless connection
- Gigabit Ethernet enables fast transfer of large colour files across the network

### Simple to Set up, Use and Own

- New simple Set up
- Firmware update through portal
- Video guidance on cons change
- Quiet mode for small offices

## Consumables

Product	Life	Part No.
Starter Toners	1,000	n/a
Cyan Toner	1,500/ 3,000	46508715 46508711
Magenta Toner	1,500/ 3,000	46508714 46508710
Yellow Toner	1,500/ 3,000	46508713 46508709
Black Toner	1,500/ 3,500	46508716 46508712
Drum Unit (M/C)	30/20k	44968301
Fuser Unit	60,000	44472603
Transfer Belt	60,000	44472202

## Accessories

- **2<sup>nd</sup> Paper Tray (44472102)**  
Add an additional paper tray for improved flexibility and increased capacity - capacity 530 sheets
- **Cabinet (01314101)**  
For positioning of the MC363 anywhere in the office providing paper and consumables storage
- **Wireless LAN - (45830202)**  
Optional wireless LAN Module



Scan QR Code on consumables packaging for installation video

# The OKI MC563dn

A4

COPY

PCL/PS

33.6Kbps Fax

SCAN

Auto Duplex Print/Copy/Scan

# OKI

## MC563dn (EURO) 46357132

- Gigabit Ethernet, USB 2.0 and Optional Wireless
- Auto Duplex (Up to 350 sheets)



## MC563 with 2<sup>nd</sup> and 3<sup>rd</sup> paper tray

(Up to 1,410 sheets)



Optional card release



## MC563dn Print – Copy – Scan – Fax

- 30/30ppm print speed – New engine!
- 1200x1200 dpi print quality
- 1,410 sheets, with 2 optional trays
- 1GB RAM memory
- Citrix XenApp compatible
- AirPrint & Google Cloud Print 2.0
- Gigabit Ethernet
- Wireless Direct – Concurrent Wired and Wireless connection
- Private Print
- Optional card release
- Shared Print
- Troubleshooting through OKI app

## Consumables

Product	Life	Part No.
Starter Toners	2,000	n/a
Cyan Toner	1,500	46490403
Cyan Toner	6,000	46490607
Magenta Toner	1,500	46490402
Magenta Toner	6,000	46490606
Yellow Toner	1,500	46490401
Yellow Toner	6,000	46490605
Black Toner	1,500	46490404
Black Toner	7,000	46490608
Drum Cyan	30,000	46484107
Drum Magenta	30,000	46484106
Drum Yellow	30,000	46484105
Drum Black	30,000	46484108
Fuser Unit	60,000	46358502
Transfer Belt	60,000	46394902

## Accessories

- **2<sup>nd</sup> Paper Tray (46361802)**  
Add up to 2 additional paper tray and increased paper capacity of 1,410 sheets
- **Cabinet (46567701)**  
For Safe and attractive positioning of the C531dn anywhere in the office providing paper and consumables storage
- **Wireless LAN (45830202)**
- **Card Reader Lock in Kit (46566001)**  
Space next to panel to neatly place card reader. Use this accessory to secure the card reader in place, so that so user can walk away with the reader. Place a sticker on top to indicate where to swipe the card.

Scan QR Code on consumables packaging for installation video



\* Blue Angel certification from April 2017

# The OKI MC573dn

A4

COPY

PCL/PS

33.6Kbps Fax

SCAN

Auto Duplex Print/Copy/Scan

# OKI

## MC573dn (EURO) 46357102

- Gigabit Ethernet, USB 2.0 and Optional Wireless
- Auto Duplex (Up to 350 sheets)



## MC573 with 2<sup>nd</sup> and 3<sup>rd</sup> paper tray

(Up to 1,410 sheets)



Easily customisable 7" colour touch screen

Optional card release

OKI Open platform sXP allows for integration with software solutions like SENDYS Explorer



## MC573dn Print – Copy – Scan – Fax

### sXP Connectivity to Document Management

- 30/30ppm print speed – New engine!
- 1200x1200 dpi print quality
- 1,410 sheets, with 2 optional trays
- 1GB RAM memory
- Citrix XenApp compatible
- AirPrint & Google Cloud Print 2.0
- Gigabit Ethernet
- Wireless Direct – Concurrent Wired and Wireless connection
- 7" Colour Touch screen – quick and easy to customise
- Private Print
- Optional card release
- Shared Print
- Troubleshooting on device screen and through OKI app

### Open Architecture sXP2

- Connectivity into pull printing fleet
- Ability to run 3rd party software (Drivve, PaperCut, SENDYS Explorer)
- SENDYS Explorer Lite at no cost
- SDK for tailor-made solutions

## Consumables

Product	Life	Part No.
Starter Toners	2,000	n/a
Cyan Toner	1,500	46490403
Cyan Toner	6,000	46490607
Magenta Toner	1,500	46490402
Magenta Toner	6,000	46490606
Yellow Toner	1,500	46490401
Yellow Toner	6,000	46490605
Black Toner	1,500	46490404
Black Toner	7,000	46490608
Drum Cyan	30,000	46484107
Drum Magenta	30,000	46484106
Drum Yellow	30,000	46484105
Drum Black	30,000	46484108
Fuser Unit	60,000	46358502
Transfer Belt	60,000	46394902

## Accessories

- **2<sup>nd</sup> Paper Tray (46361802)**  
Add up to 2 additional paper tray and increased paper capacity of 1,410 sheets
- **Cabinet (46567701)**  
For Safe and attractive positioning of the C531dn anywhere in the office providing paper and consumables storage
- **Wireless LAN (45830202)**
- **Card Reader Lock in Kit (46566001)**  
Space next to panel to neatly place card reader. Use this accessory to secure the card reader in place, so that so user can walk away with the reader. Place a sticker on top to indicate where to swipe the card.

Scan QR Code on consumables packaging for installation video



\* Blue Angel certification from April 2017

# The OKI MC760

A4

COPY

PCL/PS

SCAN

Auto Duplex Print/Copy/Scan

33.6Kbps Fax

# OKI

**MC760dn (MULTI) 45376013**  
**MC760dn (2AC) 01334301**

**MC760dnfax (EURO) 45376014**  
**MC760dnfax (2AC) 01334302**



**Integrated Offline Stapler**



## Example configurations



With 2<sup>nd</sup>/3<sup>rd</sup> trays and Castor Base

- 1,690 sheets



With HCF

- 2,630 sheets



With 2<sup>nd</sup>/3<sup>rd</sup>/4<sup>th</sup> trays and Castor Base

- 2,220 sheets



With 2<sup>nd</sup> tray & HCF

- 3,160 sheets

## MC760 Print – Copy – Scan – Fax (dnfax version)

### Choice of models, Standard 'dn' or fax model 'dnfax'

- Colour printing, copying, scanning and faxing
- 9" (23cm) colour display
- 28ppm colour and mono copy and print speeds
- Scan to email (LDAP), network PC and USB memory
- 100 sheet RADF scanner for double sided copying and scanning
- Standard duplex printing (220gsm)
- Standard paper capacity 630 sheets including 100 sheet multipurpose tray
- Optional 530 sheets additional trays or 2000 sheet large capacity feeder.
- Max paper capacity 3,160 sheets
- Media weight up to 250gsm from MPT and 220gsm from all other trays
- PCL and PS3 emulations
- 2GB memory with 1.2Ghz Processor for fast print processing
- Deep sleep mode (<2.0W)
- Active Directory for user access control
- Open architecture for support of third party software solutions
- Secure print, Password protected PDF, IPsec, IC card release
- Standard capacity 8k black and 6k colour toners
- Convenient integrated stapler
- 100,000 page per month duty cycle
- Energy Star compliant

**Note:**  
Toner Yields are based on ISO 19798

## Consumables

Product	Life	Part No.
Starter Toners	4,800	n/a
Cyan Toner	6,000	45396303
Magenta Toner	6,000	45396302
Yellow Toner	6,000	45396301
Black Toner	8,000	45396304
Cyan Drum	30,000	45395703
Magenta Drum	30,000	45395702
Yellow Drum	30,000	45395701
Black Drum	30,000	45395704
Fuser Unit	60,000	45380003
Transfer Belt	60,000	45381102
Staples STD	3,000	45513301
Staples Finisher	15,000	42937603

## Accessories

- **Additional Paper Trays (45466502)**  
Adds up to three additional paper trays for improved paper flexibility and increased capacity - 530 sheets each tray.  
**Note: Castor Base (45466602) must be fitted with trays**
- **Large Capacity Feeder (LCF) (45393302)**  
Adds additional 2,000 sheet capacity
- **Data Overwrite Enabler (45518101)** to auto-erase copy, print and scan data;  
**IPsec Enabler (45518401)** to add IPsec encryption technology;  
**Meta Scan Enabler (45518201)** to enable the addition of extra data to scanned images
- **IC Card Readers complete with bracket: Mifare Type (45518601); HID Type (45518501)**  
Card readers for user authentication
- **Wireless Networking: Wireless kit(45517901); Antenna (45518001)**  
Add wireless networking – **Note:** Requires Engineer Installation

# The OKI MC770

A4

COPY

PCL/PS

SCAN

Auto Duplex Print/Copy/Scan

33.6Kbps Fax

# OKI

MC770dnfax (MULTI) 45376114  
MC770dnfax (2AC) 01334303



**Integrated Offline Stapler**

## Example configurations



With 2<sup>nd</sup>/3<sup>rd</sup> trays and Castor Base  
• 1,690 sheets



With HCF  
• 2,630 sheets



With 2<sup>nd</sup>/3<sup>rd</sup>/4<sup>th</sup> trays and Castor Base  
• 2,220 sheets



With 2<sup>nd</sup> tray & HCF  
• 3,160 sheets

## MC770 Print – Copy – Scan – Fax

### Standard 'dnfax' model

- Colour printing, copying, scanning and faxing
- 9" (23cm) colour display
- 34ppm colour and 36ppm mono copy and print speeds
- Scan to email (LDAP), network PC and USB memory
- 100 sheet RADF scanner for double sided copying and scanning
- Standard duplex printing (220gsm)
- Standard paper capacity 630 sheets including 100 sheet multipurpose tray
- Optional 530 sheets additional trays or 2000 sheet large capacity feeder.
- Max paper capacity 3,160 sheets
- Media weight up to 250gsm from MPT and 220gsm from all other trays
- PCL and PS3 emulations
- 2GB memory with 1.2Ghz Processor for fast print processing
- Deep sleep mode (<2.0W)
- Active Directory for user access control
- Open architecture for support of third party software solutions
- Secure print, Password protected PDF, IPsec, IC card release
- High capacity 15k black and 11.5k colour toners
- Convenient integrated stapler
- 100,000 page per month duty cycle
- Energy Star compliant

**Note:**  
Can also take the standard capacity toners – see MC760. Toner Yields are based on ISO 19798

## Consumables

Product	Life	Part No.
Starter Toners	4,800	n/a
Cyan Toner	11,500	45396203
Magenta Toner	11,500	45396202
Yellow Toner	11,500	45396201
Black Toner	15,000	45396204
Cyan Drum	30,000	45395703
Magenta Drum	30,000	45395702
Yellow Drum	30,000	45395701
Black Drum	30,000	45395704
Fuser Unit	60,000	45380003
Transfer Belt	60,000	45381102
Staples STD	3,000	45513301
Staples Finisher	15,000	42937603

## Accessories

- **Additional Paper Trays (45466502)**  
Adds up to three additional paper trays for improved paper flexibility and increased capacity - 530 sheets each tray.  
**Note: Castor Base (45466602) must be fitted with trays**
- **Large Capacity Feeder (LCF) (45393302)**  
Adds additional 2,000 sheet capacity
- **Data Overwrite Enabler (45518101)** to auto-erase copy, print and scan data;  
**IPsec Enabler (45518401)** to add IPsec encryption technology;  
**Meta Scan Enabler (45518201)** to enable the addition of extra data to scanned images
- **IC Card Readers complete with bracket: Mifare Type (45518601); HID Type (45518501)**  
Card readers for user authentication
- **Wireless Networking: Wireless kit(45517901); Antenna (45518001)**  
Add wireless networking – **Note:** Requires Engineer Installation

# The OKI MC780

A4

COPY

PCL/PS

SCAN

Auto Duplex Print/Copy/Scan

33.6Kbps Fax

# OKI

MC780dfnfx (MULTI) 45377014  
MC780dfnfx (2AC) 01334304

### Includes Internal Finisher

- 500 Sheet Capacity
- 50 Sheet Staple



Finisher

### Example configurations



- With 2<sup>nd</sup>/3<sup>rd</sup> trays and Castor Base
- 1,690 sheets



- With HCF
- 2,630 sheets



- With 2<sup>nd</sup>/3<sup>rd</sup>/4<sup>th</sup> trays and Castor Base
- 2,220 sheets



- With 2<sup>nd</sup> tray & HCF
- 3,160 sheets



## MC780 Print – Copy – Scan – Fax

### Standard 'dfnfx' model - Includes internal finisher

- Colour printing, copying, scanning and faxing
- 9" (23cm) colour display
- 40ppm colour and 40ppm mono copy and print speeds
- Scan to email (LDAP), network PC and USB memory
- 100 sheet RADF scanner for double sided copying and scanning
- Standard duplex printing (220gsm)
- Standard paper capacity 630 sheets including 100 sheet multipurpose tray
- Optional 530 sheets additional trays or 2000 sheet large capacity feeder.
- Max paper capacity 3,160 sheets
- Media weight up to 250gsm from MPT and 220gsm from all other trays
- PCL and PS3 emulations
- 2GB memory with 1.2Ghz Processor for fast print processing
- Deep sleep mode (<2.0W)
- Active Directory for user access control
- Open architecture for support of third party software solutions
- Secure print, Password protected PDF, IPsec, IC card release
- High capacity 15k black and 11.5k colour toners
- Internal Finisher (Sorting and Stapling)
- 100,000 page per month duty cycle
- Energy Star compliant

**Note:**  
Can also take the standard capacity toners – see MC760. Toner Yields are based on ISO 19798

## Consumables

Product	Life	Part No.
Starter Toners	4,800	n/a
Cyan Toner	11,500	45396203
Magenta Toner	11,500	45396202
Yellow Toner	11,500	45396201
Black Toner	15,000	45396204
Cyan Drum	30,000	45395703
Magenta Drum	30,000	45395702
Yellow Drum	30,000	45395701
Black Drum	30,000	45395704
Fuser Unit	60,000	45380003
Transfer Belt	60,000	45381102
Staples STD	3,000	45513301
Staples Finisher	15,000	42937603

## Accessories

- **Additional Paper Trays (45466502)**  
Adds up to three additional paper trays for improved paper flexibility and increased capacity - 530 sheets each tray.  
**Note: Castor Base (45466602) must be fitted with trays**
- **Large Capacity Feeder (LCF) (45393302)**  
Adds additional 2,000 sheet capacity
- **Data Overwrite Enabler (45518101)** to auto-erase copy, print and scan data;  
**IPsec Enabler (45518401)** to add IPsec encryption technology;  
**Meta Scan Enabler (45518201)** to enable the addition of extra data to scanned images
- **IC Card Readers complete with bracket: Mifare Type (45518601); HID Type (45518501)**  
Card readers for user authentication
- **Wireless Networking: Wireless kit(45517901); Antenna (45518001)**  
Add wireless networking – **Note:** Requires Engineer Installation

# The OKI MC700 Series – Accessories Overview

# OKI

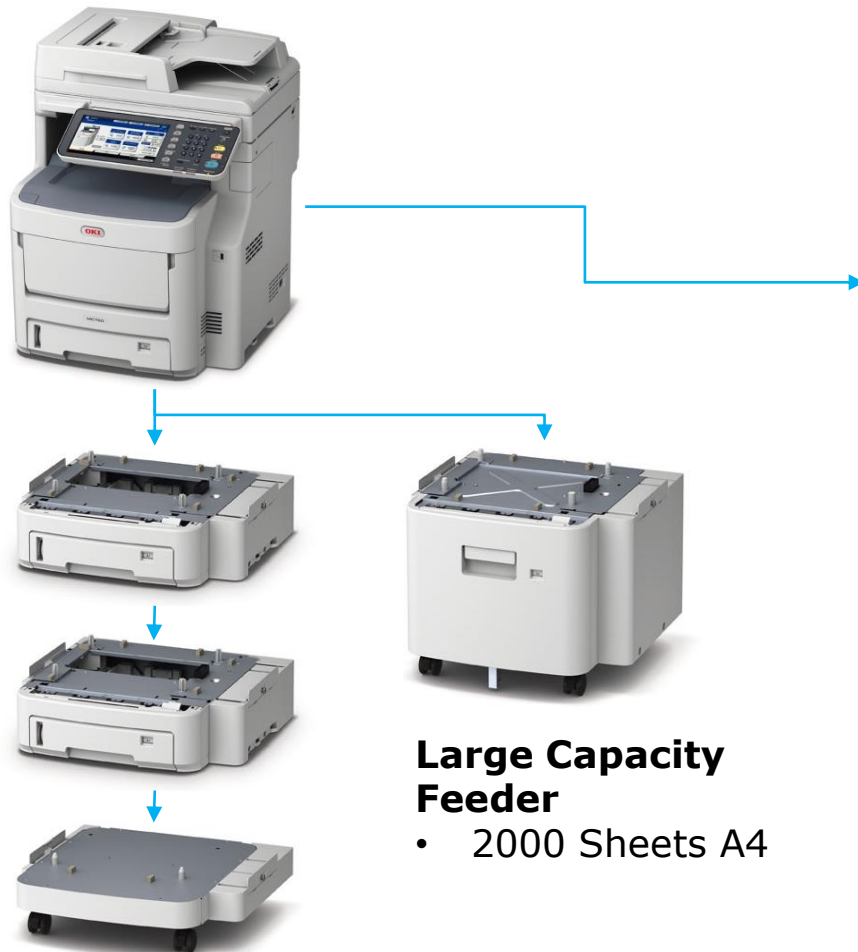

## Large Capacity Feeder

- 2000 Sheets A4

## Additional Trays

- 530 Sheets A4
- Castor Base

**Note:** It is recommended that only the base model (without additional trays) is used on a desktop. When used in floor standing configuration, the castor base must be fitted. The castor base includes stability feet (not shown) which must also be fitted.



## Data Overwrite Enabler

Automatically overwrites data. Data is overwritten immediately following the completion of the copy, print or scan job.



## IPSec Enabler

This optional protocol prevents communication contents from being viewed or tampered with in the communication path when using an application that does not support encryption.



## Meta Scan Enabler

Meta Scan – This is to enable the function of adding meta data to the scanning function. This allows a Meta Scan to control the scan workflow in existing business systems using meta data relating to each document.



## IC Card Readers

- HID
- Mifare

Card Readers automatically log users into the device when a valid card is in the proximity of the reader.



## Wireless Network

Add wireless networking

**Note:** Requires both the Wireless kit (45517901) & Antenna (45518001) and requires Engineer Installation

**Note:** Other types of access control devices November be able to be used. Please contact OKI for details of compatible devices or to find more information

# The OKI MC853

A3/A4

COPY

PCL/PS

33.6Kbps Fax

SCAN

Auto Duplex Print/Copy/Scan

# OKI

**MC853dn (EURO) 45850404**  
**MC853dn (2AC) 45850603**

- 23/23ppm (c/m) print speeds
- Large 7" LC D colour touch screen
- 100 Sheet RADF
- Auto duplex print, copy, scan & Fax
- Paper Capacity up to 400 sheets
- Standard integrated offline stapler
- 2<sup>nd</sup> Output Tray



Ergonomic, auto tilting screen with onscreen guided help functionality

2<sup>nd</sup> output tray – divert prints, faxes or copies to specific output trays (user selectable)

Standard integrated offline stapler

**MC853dnct (EURO) 45850601**  
**MC853dnct (2AC) 45850604**

As MC853dn with 2<sup>nd</sup> tray and Cabinet

- 935 Sheets



**MC853dnv (EURO) 45850602**  
**MC853dnv (2AC) 45850605**

As MC853dn with 2<sup>nd</sup>/3<sup>rd</sup>/4<sup>th</sup> trays and Caster Base

- 2,005 Sheets



## MC853 Print – Copy – Scan – Fax

• **The versatile smart MFP, simple to use and seamlessly integrated into document workflow**

- Print/Copy speed 23ppm colour/mono (13ppm - A3)
- Simple to use and fully customisable 7" LCD Colour touch screen display
- Compact, fully featured A3 colour MFP delivering superb value for money

### Print

- PCL6, PCL5c, PostScript 3 emulations and encrypted secure print as standard
- ProQ2400 Multi-level technology with High Definition Toner
- Auto sensing multi-purpose tray for printing a wide variety of media sizes and weights, from A6 to 1.3m long banners and up to 256gsm.

### Copy

- Fast, high quality colour copying with a first copy out time of 14.5 seconds
- Job macro function enables the user to programme frequently used copy settings for fast, one touch access

### Scan

- Scan to E-Mail (Full LDAP support), local PC, Network and USB (Front)
- Scan to PDF, TIFF, JPEG and XPS with high compression to reduce file size

### Fax

- Super G3 33.6kbps modem with 1,000 speed dials, 32 group dials
- Block junk faxes and store and view incoming faxes on 7" display

## Consumables

Product	Life	Order No.
Starter Toner	2,500	N/A
Cyan Toner	7,300	45862839
Magenta Toner	7,300	45862838
Yellow Toner	7,300	45862837
Black Toner	7,000	45862840
Cyan Drum	30,000	44844471
Magenta Drum	30,000	44844470
Yellow Drum	30,000	44844469
Black Drum	30,000	44844472
Transfer Belt	80,000	44846204
Fuser Unit	100,000	44848805

## Accessories

### • Option Tray (45887302)

Add an additional paper tray for improved flexibility and increased capacity – each tray holds 535 sheets. **For use with dn and dnct models only (maximum 3 trays in total - 2,005 sheets)**

### • Cabinet (45893702)

For safe and attractive positioning of the MC853 anywhere in the office providing paper and consumable storage

### • Caster Base (45889502)

Together with option trays the caster base will transform dn configurations in to an easily maneuverable free standing unit.

### • Wireless LAN Module (45830202)

- Make positioning and sharing easy with Wireless interfacing



# The OKI MC873

- A3/A4
- COPY
- PCL/PS
- 33.6Kbps Fax
- SCAN
- Auto Duplex Print/Copy/Scan



<b>MC873dn (EURO) 45850204</b> <b>MC873dn (2AC) 45850623</b>	<b>MC873dnct (EURO) 45850621</b> <b>MC873dnct (2AC) 45850624</b>	<b>MC873dnv (EURO) 45850622</b> <b>MC873dnv (2AC) 45850625</b>
---	---	---

- 35/35ppm (c/m) print speeds
- Large 7" LC D colour touch screen
- 100 Sheet RADF
- Auto duplex print, copy, scan & Fax
- Paper Capacity up to 400 sheets
- Standard integrated offline stapler
- 2<sup>nd</sup> Output Tray

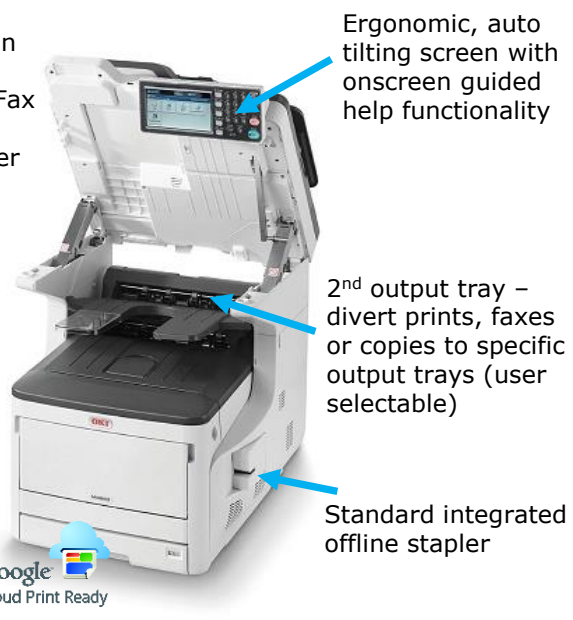

- As MC873dn with 2<sup>nd</sup> tray and Cabinet
- 935 Sheets



- As MC873dn with 2<sup>nd</sup>/3<sup>rd</sup>/4<sup>th</sup> trays and Caster Base
- 2,005 Sheets



MC873 Print – Copy – Scan – Fax	Consumables	Accessories
---------------------------------	-------------	-------------

- Advanced functionality, versatility and document workflow integration for the larger workgroup**
  - Print/Copy speed 35ppm colour/mono (20ppm - A3)
  - Simple to use and fully customisable 7" LCD Colour touch screen display
  - Compact, fully featured A3 colour MFP delivering superb value for money
- Print**
- PCL6, PCL5c, PostScript 3 emulations and encrypted secure print as standard
  - ProQ2400 Multi-level technology with High Definition Toner
  - Auto sensing multi-purpose tray for printing a wide variety of media sizes and weights, from A6 to 1.3m long banners and up to 256gsm.
- Copy**
- Fast, high quality colour copying with a first copy out time of just 10 seconds
  - Job macro function enables the user to programme frequently used copy settings for fast, one touch access
- Scan**
- Scan to E-Mail (Full LDAP support), local PC, Network and USB (Front)
  - Scan to PDF, TIFF, JPEG and XPS with high compression to reduce file size
- Fax**
- Super G3 33.6kbps modem with 1,000 speed dials, 32 group dials
  - Block junk faxes and store and view incoming faxes on 7" display

Product	Life	Order No.
Starter Toner	2,500	N/A
Cyan Toner	7,300 10,000	45862839 45862816
Magenta Toner	7,300 10,000	45862838 45862815
Yellow Toner	7,300 10,000	45862837 45862814
Black Toner	7,000 15,000	45862840 45862818
Cyan Drum	30,000	44844471
Magenta Drum	30,000	44844470
Yellow Drum	30,000	44844469
Black Drum	30,000	44844472
Transfer Belt	80,000	44846204
Fuser Unit	100,000	44848805

- Option Tray (45887302)**  
Add an additional paper tray for improved flexibility and increased capacity – each tray holds 535 sheets. **For use with dn and dnct models only (maximum 3 trays in total - 2,005 sheets)**
- Cabinet (45893702)**  
For safe and attractive positioning of the MC873 anywhere in the office providing paper and consumable storage
- Caster Base (45889502)**  
Together with option trays the caster base will transform dn configurations in to an easily maneuverable free standing unit.
- Wireless LAN Module (45830202)**  
Make positioning and sharing easy with Wireless interfacing

## OKI SIDM Printer Range Guide



## The OKI ML1120eco Dot Matrix Printer

**ML1120eco (EURO) 43471831**  
**ML1120eco (2AC) 01329901**

- 80 Column



- ➔ Top FEED  
Single cut-sheet paper
- ➔ Rear FEED  
Continuous paper
- ➔ Bottom FEED  
Continuous paper

### Applications Table

<b>Printing multi-part invoices, picking lists and receipts</b>	Printing on multi-part (up to 5 parts) paper to provide copies for picking lists, invoicing, record keeping and dispatch with goods. Using either bottom or rear feed, continuous forms tractor paper.
<b>Data recording and listings</b>	Reliable, accurate printing of data output from control and monitoring systems. On single or multipart continuous forms paper, using bottom or rear tractor feed.
<b>Printing pre-printed letter head paper &amp; forms</b>	Top feeding (friction feed) and printing of pre-printed forms or letters (single sheet or multi-part paper).
<b>Labels printing</b>	Rear feed possible with good quality labels. Bottom feed recommended for a straight paper path with the tractor in top position.

### ML1120

- **Easily accommodated in the smallest of spaces the ML1120 quickly delivers high quality multi-part documents with ease**
- **An low cost, highly reliable light duty 9-pin printing solution, perfect for many listing and point of sales applications**

- 9-Pin printer with a Graphics resolution up to 240 x 216dpi
- Maximum print speed of 375cps in High Speed Draft (10cpi)
- Fastest NLQ print speed 62.5cps (10cpi)
- Small footprint (slightly larger than A4 paper) 150 x 349 x 232mm (HxWxD)
- Number of copies 5 (original plus 4 copies)
- Printer Emulations - Epson LX, IBM Graphics and OKI Microline
- Resident fonts: SSD, HSD, Utility, NLQ & Barcodes
- Auto paper load, paper park & low tear-off as standard
- Highly versatile paper handling - top friction and bottom/rear tractor feeds
- Interchangeable tractor unit – top position for bottom pull feed and rear position for rear push feed.
- First printable line (from top of page to centre of character) is 2.12mm for cut sheet and 2.12mm for continuous form paper
- USB, Parallel and RS232 interfaces as standard
- Ribbon Life 4 Million characters
- Robust 400 Million strokes per wire print head
- Mean Time Between Failures (MTBF) 10,000 hours

### Consumables

Product	Life in Characters	Order No.
Black Ribbon	4 Million	43571802

### Accessories

- **There are no accessories for this product**

# The OKI ML280 Elite Dot Matrix Printer



**ML280P Elite (EURO) 01138602**  
**ML280P Elite (2AC) 01138603**

**ML280S Elite (EURO) 01138606**  
**ML280S Elite (2AC) 01138607**

- Parallel & USB Interface
- 80 Column

- Serial & USB Interface
- 80 Column

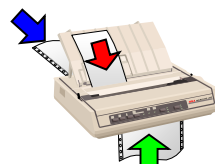

→ Top FEED  
Single cut-sheet paper

→ Rear FEED  
Continuous paper

→ Bottom FEED  
Continuous paper



## Applications Table

<b>Printing pre-printed letter head paper, tickets, cheques &amp; forms</b>	Top feeding (friction feed) forms or individual sheets of letter headed paper or pre-perforated continuous tickets or labels. (Single sheet or multi-part paper)
<b>Invoices, dispatch notes and receipts</b>	Either bottom or rear platen pin feeding of full width continuous multi-part paper
<b>Labels printing</b>	Rear feed possible with good quality labels. Bottom feed recommended for a straight paper path. Opt. pull tractor required.
<b>Passenger lists or call logs</b>	Continuous roll paper can be friction feed through the printer and torn to length. Opt. Roll Paper Stand required

**ML280 Elite DC** For printing any of the above in remote or mobile applications in cars, lorries or ships

## ML280 Elite

- **Compact low-profile printer that's ideal for under counter positioning in point of sale and workstation applications**
- **For medium duty applications in environments with extremes of temperature, humidity and high levels of dust**

- 9-Pin printer with a Graphics resolution up to 240 x 216dpi
- Maximum print speed of 375cps (12cpi) in super speed draft
- Fastest NLQ print speed 62.5cps (all cpi)
- Carriage width 80 columns at 10cpi
- Number of copies 4 (original plus 3 copies)
- Printer Emulation OKI MicroLine (ML), Epson LX and IBM Graphics
- Resident fonts: Utility, High Speed Draft, NLQ and Barcodes
- Auto paper load, Platen pin feed and low tear-off as standard
- Highly versatile top, bottom and rear paper feeds
- First printable line (from top of page) is 15mm for cut sheet paper and 16.9mm for continuous form paper
- USB and Parallel interfaces as standard
- Ribbon Life 3 Million characters
- Robust 200 Million character print head
- Mean Time Between Failures (MTBF) 20,000 hours

## Consumables

Product	Life in Characters	Order No.
Black Ribbon	3 Million	09002303

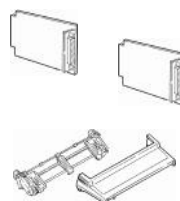

## Accessories

- **RS232 Serial Interface (09002353)** connections up to 15m
- **RS422 Serial Interface (09002357)** connections up to 15m
- **Pull Tractor (09002363)**  
Feeding continuous paper from 76.2 to 254mm wide
- **Roll Paper Stand (09002334)**  
For feeding continuous rolls from 214 to 216mm wide and up to 128mm in diameter (Core diameter 25mm)

## The OKI ML320 Elite Dot Matrix Printer

### ML320 Elite ML (UK) 09000186

- MicroLine Emulation
- 80 Column



### ML320 Elite I/E (UK) 09000180

- IBM/Epson Emulation
- 80 Column

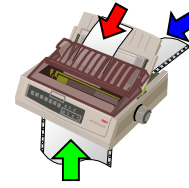

- Top FEED  
Single cut-sheet paper
- Rear FEED  
Continuous paper
- Bottom FEED  
Continuous paper



### Applications Table

<b>Printing pre-printed letter head paper, and forms</b>	Top feeding (friction feed) forms or individual sheets of letter headed paper (Single sheet or multi-part paper)
<b>Reports</b>	Either front or rear feed continuous paper for super fast overnight printing of reports
<b>Printing multi-part invoices, picking lists and receipts.</b>	Either bottom or rear feed multi-part paper up to 5 copies to provide picking lists, copies for dispatch with goods, invoicing and record keeping.
<b>Continuous feed label, ticket &amp; cheque printing</b>	Bottom feed for a straight paper path (prevent snagging) of pre-perforated ticket or label paper. Opt. tractor unit required.
<b>Passenger lists or call logs (Normally ML320 only)</b>	Continuous roll paper can be friction feed through the printer and torn to length. Opt. Roll Paper Stand required

### ML320

- **Robust, fast and highly versatile desktop printers**
- **For high duty applications they are equipped with powerful line feed motors making them especially suited to applications with lots of paper movement.**
- 9-Pin printer with a Graphics resolution up to 240 x 216dpi
- Maximum print speed of 360cps (12cpi) in super speed draft
- Fastest NLQ print speed 63cps (all cpi)
- Carriage widths 80 or 136 columns at 10cpi
- Number of copies 5 (original plus 4 copies)
- Printer Emulation MicroLine (ML) or Epson LX, IBM Graphics/ProPrinter
- Resident fonts: Utility, High Speed Draft, NLQ NLQ-Courier, NLQ-San Serif
- Auto paper load, paper park, rear push tractor & low tear-off
- Highly versatile top, bottom and rear paper feeds
- First printable line (from top of page) is 23.4mm for both cut sheet paper and continuous form paper
- Parallel interfaces as standard
- Robust 200 Million character print head
- Mean Time Between Failures (MTBF) 5,000 hours

### Consumables

Product	Life in Characters	Order No.
Black Ribbon	3 Million	09002303

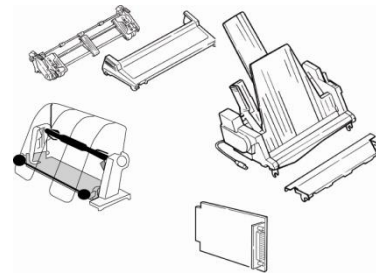

### Accessories

- **RS232 Serial Interface (09002351)** connections up to 15m
- **RS422 Serial Interface (09002356)** connections up to 15m
- **Current Loop Interface (09000684)** connection up to 1km
- **Pull Tractor – ML320 (09002375)**  
Top mounted for bottom feeding of continuous paper from 76.2 to 254mm wide
- **Single Bin Cut Sheet Feeder – ML320 (09000700)**  
For automatic feeding of multiple single sheets of paper from 76.2 to 254mm wide
- **Roll Paper Stand (09002334) Adaptor (09400034)**  
For feeding continuous rolls from 214 to 216mm wide and up to 128mm in diameter (Core diameter 25mm)

## The OKI ML3320/1eco Dot Matrix Printer

**ML3320eco (EURO) 01308201**  
**ML3320eco (2AC) 01308203**

- 80 Column



**ML3321eco (EURO) 01308301**  
**ML3321eco (2AC) 01308303**

- 136 Column

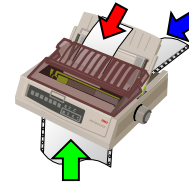

- **Top FEED**  
Single cut-sheet paper
- **Rear FEED**  
Continuous paper
- **Bottom FEED**  
Continuous paper



### Applications Table

<b>Printing pre-printed letter head paper, and forms</b>	Top feeding (friction feed) forms or individual sheets of letter headed paper (Single sheet or multi-part paper)
<b>Reports</b>	Either front or rear feed continuous paper for super fast overnight printing of reports
<b>Printing multi-part invoices, picking lists and receipts.</b>	Either bottom or rear feed multi-part paper up to 5 copies to provide picking lists, copies for dispatch with goods, invoicing and record keeping.
<b>Continuous feed label, ticket &amp; cheque printing</b>	Bottom feed for a straight paper path (prevent snagging) of pre-perforated ticket or label paper. Opt. tractor unit required.
<b>Passenger lists or call logs (Normally ML3320eco only)</b>	Continuous roll paper can be friction feed through the printer and torn to length. Opt. Roll Paper Stand required

### ML3320/1eco

- **Reliable, fast and environmentally friendly 9-pin printers that deliver superb value for money**
- **They are fast, reliable and easy to use and with barcode printing as standard they make the ideal printer for customer service points in wholesale, retail and service environments.**

- 9-Pin printer with a graphics resolution up to 240 x 216dpi
- Eco-friendly technology saves energy, "Sleep mode" consumes just 1.5W
- Maximum print speed of 435cps (12cpi) in super speed draft
- Fastest NLQ print speed 73cps (12/10cpi)
- Carriage widths 80 or 136 columns at 10cpi
- Number of copies 5 (original plus 4 copies)
- Printer Emulation Epson FX, IBM ProPrinter, OKI MicroLine (ML)
- Resident fonts: Utility, High Speed Draft, NLQ-Courier (Scalable), NLQ-Gothic (Scalable) OCR-B and Barcodes
- Auto paper load, paper park, rear push tractor & low tear-off
- Highly versatile top, bottom and rear paper feeds
- First printable line (from top of page) is 0.5mm for both cut sheet paper and continuous form paper
- USB and Parallel interfaces as standard
- Optional Network and RS232 interfaces
- Robust 200 Million character print head
- Mean Time Between Failures (MTBF) 10,000 hours

### Consumables

Product	Life in Characters	Order No.
Black Ribbon	3 Million	09002303

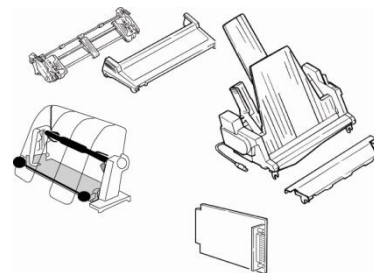

### Accessories

- **RS232 Serial Interface (44455102)** connections up to 15m
- **OKILAN 7130e Network Card (45268706)**
- **Pull Tractor – ML3320eco (09002365)**
- **Pull Tractor – ML3321eco (09002369)**  
Top mounted for bottom feeding of continuous paper from 76.2 to 254mm wide (406.5mm on the ML3321eco)
- **Push Tractor – ML3320eco (09002366)**
- **Push Tractor – ML3321eco (09002370)**  
Bottom mounted for push feeding of continuous paper from 76.2 to 254mm wide (406.5mm on the ML3321eco)
- **Single Bin Cut Sheet Feeder – ML3320eco (44497402)**
- **Single Bin Cut Sheet Feeder – ML3321eco (44497502)**  
For automatic feeding of multiple single sheets of paper from 76.2 to 254mm wide (406.5mm on ML3321eco)
- **Roll Paper Stand (09002332)**  
For feeding continuous rolls from 214 to 216mm wide and up to 128mm in diameter (Core diameter 25mm)

## The OKI ML5520/1eco Dot Matrix Printer

**ML5520eco (EURO) 01308601**  
**ML5520eco (2AC) 01308603**

**ML5521eco (EURO) 01308701**  
**ML5521eco (2AC) 01308703**

- 80 Column

- 136 Column

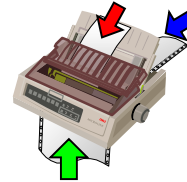

- **Top FEED**  
Single cut-sheet paper
- **Rear FEED**  
Continuous paper
- **Bottom FEED**  
Continuous paper



### Applications Table

<b>Printing pre-printed letter head paper, and forms</b>	Top feeding (friction feed) forms or individual sheets of letter headed paper (Single sheet or multi-part paper)
<b>Reports</b>	Either front or rear feed continuous paper for super fast overnight printing of reports
<b>Printing multi-part invoices, picking lists and receipts.</b>	Either bottom or rear feed multi-part paper up to 6 copies to provide picking lists, copies for dispatch with goods, invoicing and record keeping.
<b>Continuous feed label, ticket &amp; cheque printing</b>	Bottom feed for a straight paper path (prevent snagging) of pre-perforated ticket or label paper. Opt. tractor unit required.
<b>Passenger lists or call logs (Normally ML5520eco only)</b>	Continuous roll paper can be friction feed through the printer and torn to length. Opt. Roll Paper Stand required

### ML5520/1eco

- **High performance, eco-friendly 9-pin printers that are perfect for high volume document production**
- **Super fast printing and throughput a robust construction and versatile paper handling make them perfect for printing invoices, picking lists, spread-sheets, labels and barcodes.**

- 9-Pin printer with a graphics resolution up to 240 x 216dpi
- Eco-friendly technology saves energy, "Sleep mode" consumes just 1.5W
- Maximum print speed of 570cps (12cpi) in super speed draft
- Fastest NLQ print speed 95cps (All cpi)
- Carriage widths 80 or 136 columns at 10cpi
- Number of copies 6 (original plus 5 copies)
- Printer Emulation Epson FX, IBM ProPrinter, OKI MicroLine (ML)
- Resident fonts: Utility, High Speed Draft, NLQ-Courier (Scalable), NLQ-Gothic (Scalable) OCR-B and Barcodes
- Auto paper load, paper park, rear push tractor & low tear-off
- Highly versatile top, bottom and rear paper feeds
- First printable line (from top of page) is 0.5mm for both cut sheet paper and continuous form paper
- USB and Parallel interfaces as standard
- Optional Network and RS232 interfaces
- Robust 200 Million character print head
- Mean Time Between Failures (MTBF) 20,000 hours

### Consumables

Product	Life in Characters	Order No.
Black Ribbon	4 Million	01126301

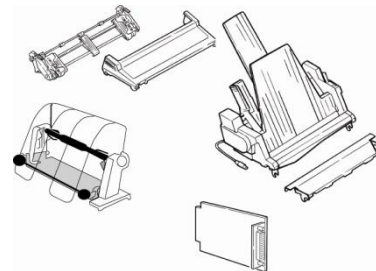

### Accessories

- **RS232 Serial Interface (44455102)** connections up to 15m
- **OKILAN 7130e Network Card (45268706)**
- **Pull Tractor – ML5520eco (09002365)**
- **Pull Tractor – ML5521eco (09002369)**  
Top mounted for bottom feeding of continuous paper from 76.2 to 254mm wide (406.5mm on the ML5521eco)
- **Push Tractor – ML5520eco (09002366)**
- **Push Tractor – ML5521eco (09002370)**  
Bottom mounted for push feeding of continuous paper from 76.2 to 254mm wide (406.5mm on the ML5521eco)
- **Single Bin Cut Sheet Feeder – ML5520eco (44497402)**
- **Single Bin Cut Sheet Feeder – ML5521eco (44497502)**  
For automatic feeding of multiple single sheets of paper from 76.2 to 254mm wide (406.5mm on ML5521eco)
- **Roll Paper Stand (09002332)**  
For feeding continuous rolls from 214 to 216mm wide and up to 128mm in diameter (Core diameter 25mm)

## The OKI ML5720/1eco Dot Matrix Printer

**ML5720eco (EURO) 44209905**  
**ML5720eco (2AC) 01268401**

**ML5721eco (EURO) 44210005**  
**ML5721eco (2AC) 01268501**

- 80 Column

- 136 Column



- Top friction FEED  
Single cut-sheet paper
- Rear tractor push FEED  
Continuous paper
- Bottom pull tractor FEED  
Continuous paper
- Front FEED  
Friction feeding Single cut-sheet paper or push feeding continuous paper

### Applications Table

<b>Printing pre-printed letter head paper and forms</b>	Top feeding (friction feed) forms or individual sheets of letter headed paper (single sheet or multi-part paper)
<b>Reports</b>	Either front or rear feed continuous paper for super fast overnight printing of reports
<b>Printing multi-part invoices, picking lists and receipts</b>	Either front or rear feed multi-part paper up to 7 copies to provide picking lists, copies for dispatch with goods, invoicing and record keeping.
<b>Continuous feed label, ticket &amp; cheque printing</b>	Bottom feed for a straight paper path to prevent snagging of pre-perforated ticket or label paper (optional Pull Tractor required).
<b>Passenger or data lists and call logs (ML5720eco only)</b>	Continuous roll paper can be friction feed through the printer and torn to length (optional Roll Paper Stand required).



### ML5720/1eco

- **High duty, high performance 9-pin dot matrix printers with truly versatile paper handling, low running costs and low energy usage.**
- **Super fast print speeds, throughput and the ability to manage heavy medias make them perfect for printing multi-part invoices, picking lists, spreadsheets, labels and barcodes.**

- 9-Pin printer with a graphics resolution up to 240 x 216dpi
- Maximum print speed of 700cps (12cpi) in Super Speed Draft
- Near Letter Quality (NLQ) print speed 113cps (10, 12 & 15cpi)
- Carriage widths 80 or 136 columns at 10cpi
- Maximum number of copies up to 7 parts
- Printer Emulation OKI MicroLine, Epson FX ESC/P, IBM Graphics/ProPrinter
- Resident fonts: Super Speed Draft, High Speed Draft, NLQ-Courier (Scalable), NLQ-Gothic (Scalable) OCR-B and Barcodes
- Auto paper load, paper park & low tear-off as standard
- Versatile top (friction), front (friction/tractor) bottom & rear feed (tractor)
- Interchangeable tractor unit – front push or rear push positions.
- First printable line (from top of page) is 0.5mm for cut sheet paper and 2.12mm for continuous form paper
- USB/Parallel interfaces as standard - Optional Network & RS232 interfaces
- Long life 400 Million character print head
- Mean Time Between Failures (MTBF) 25,000 hours
- Low power consumption 52W Draft printing and 1.5W in Sleep mode

### Consumables

Product	Life in Characters	Order No.
ML5720eco Black Ribbon	8 Million	44173405
ML5721eco Black Ribbon	13 Million	44173406

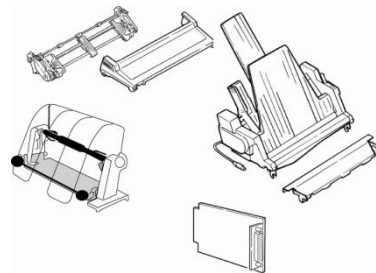

### Accessories

- **RS232 Serial Interface (44455102)** connections up to 15m
- **OKILAN 7130e Network Card (45268706)**
- **Pull Tractor – ML5720eco (44753902)**
- **Pull Tractor – ML5721eco (44754002)**  
Top mounted for bottom feeding of continuous paper from 76.2 to 254mm wide (406.5mm on the ML5721eco)
- **Push Tractor – ML5720eco (44454902)**
- **Push Tractor – ML5721eco (44455002)**  
Front or Rear mounted for push feeding of continuous paper from 76.2 to 254mm wide (406.5mm on the ML5721eco)
- **Single Bin Cut Sheet Feeder – ML5720eco (44497402)**
- **Single Bin Cut Sheet Feeder – ML5721eco (44497502)**  
For automatic feeding of multiple single sheets of paper from 76.2 to 254mm wide (406.5mm on ML5721eco)
- **Roll Paper Stand – ML5720eco only (09002332)**  
For feeding continuous rolls from 214 to 216mm wide and up to 128mm in diameter (Core diameter 25mm)



## The OKI ML3410 Dot Matrix Printer

### ML3410 I/E (MULTI) 09000269

- IBM/Epson Emulation
- 136 Column



- Top FEED  
Single cut-sheet paper
- Rear FEED  
Continuous paper
- Bottom FEED  
Continuous paper

### Applications Table

<b>Printing pre-printed letter head paper and forms</b>	Top feeding (friction feed) of pre-printed forms or individual sheets of letter headed paper (single sheet or multi-part paper)
<b>Reports</b>	Either front or rear feed continuous paper for super fast overnight printing of reports
<b>Printing multi-part invoices, picking lists, shipping &amp; export documents.</b>	Either bottom or rear feed multi-part paper up to 8 copies to provide picking lists, copies for dispatch with goods, invoicing and record keeping.
<b>Continuous feed ticket &amp; cheque printing</b>	Bottom feed for a straight paper path (prevent snagging) of pre-perforated ticket or label paper. Opt. tractor unit required.
<b>Continuous feed label printing</b>	Bottom feed for a straight paper path (prevent peeling) of pre cut labels using a top pull tractor or bottom power tractor

### ML3410

- **A workhorse, the ML3410 is a powerful, fast and very robust heavy duty printer built to handle the most data-intensive applications**
- **Powerful motors a robust construction and high impact print head make it perfect for printing large volumes of invoices, picking lists, shipping notes, export documents on up to 8 part multi-part paper.**

- 9-Pin printer with a graphics resolution up to 240 x 216dpi
- Maximum print speed of 550cps (10/12cpi) in high speed draft
- Fastest NLQ print speed 104cps (All cpi)
- Carriage width is 136 columns at 10cpi
- Number of copies 8 (original plus 7 copies)
- Printer Emulation MicroLine/Pacemark or Epson FX, IBM ProPrinter XL
- Resident fonts: Utility, High Speed Draft, NLQ-Courier, NLQ-Gothic, OCR-B and Barcodes
- Auto paper load, paper park, rear push tractor & low tear-off
- Highly versatile top, bottom and rear paper feeds (Power push tractor Opt)
- First printable line (from top of page) is 2.12mm for cut sheet and continuous form paper
- Parallel and RS232 interfaces as standard
- Optional pull tractor & bottom power push tractor for feeding heavy paper
- Robust 200 Million character print head
- Mean Time Between Failures (MTBF) 8,000 hours

### Consumables

Product	Life in Characters	Order No.
Black Ribbon	10 Million	09002308



### Accessories

- **Pull Tractor (09002377)**  
Feeding continuous paper from 76.2 to 406.5mm wide
- **Bottom Power Push Tractor (09002373)**  
Power feeding continuous paper from 76.2 to 406.5mm wide
- **Single Bin Cut Sheet Feeder (09000705)**  
Feeding single sheet paper from 76.2 to 406.5mm wide

## The OKI ML4410 Dot Matrix Printer

### ML4410 (MULTI) 00111601

- ML, IBM and Epson Emulations
- 136 Column



The ML4410 utilises an 18-pin print head working as a 9-pin device

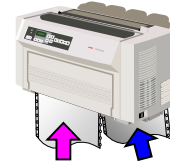

- ➔ Front FEED Continuous paper
- ➔ Rear FEED Continuous paper

### Applications Table

<b>Reports</b>	Either front or rear feed continuous paper for super fast overnight printing of reports
<b>Picking lists, dispatch notes, invoices and receipts</b>	Either front or rear feed continuous multi-part paper up to 10 parts to provide picking lists, copies for dispatch with goods, invoicing and record keeping. Pre printed multipart forms can be printed very fast and in large numbers for invoicing or receipt printing.
<b>Fast, high volume printing of product or address labels and bill printing</b>	Either front or rear feed continuous roll labels or bill printing can be done using different size labels or standard 80 column listing paper.

### ML4410

- **Robust, heavy duty listing printer that's built to power through multi-part listings at super fast speeds with complete confidence**
- **Heavy duty performance, robust build and extremely durable the ML4410 is designed to printing large volumes of invoices, dispatch notes and listings on continuous multi-part paper up to 10 parts.**
- 18-Pin printer (2 x 9pin) with a graphics resolution up to 240 x 216dpi
- Maximum print speed of 1066cps (All cpi) in high speed draft
- Fastest NLQ print speed 200cps (All cpi)
- Carriage width is 136 columns at 10cpi
- Number of copies 10 (Front Feed) and 6 (Rear Feed)
- Printer Emulation MicroLine, Epson FX and IBM ProPrinter
- Resident fonts: Utility, High Speed Draft, NLQ-Courier (Scalable), NLQ-Gothic (Scalable), OCR-B and Barcodes
- Auto paper load, paper park, rear push tractor, front push tractor, Auto bail arm, Auto Head Gap with software selectable paper paths and low tear-off
- First printable line (from top of page) is 8.9mm continuous form paper
- Parallel and RS232 interfaces as standard
- Optional purpose built stand / cabinet with paper storage and output tray
- Robust 400 Million character print head
- Mean Time Between Failures (MTBF) 12,000 hours

### Consumables

Product	Life in Characters	Order No.
Black Ribbon	15 Million	09002308

### Accessories

- **Stand / Cabinet (09002725)**  
Dedicated stand / cabinet with paper storage and output tray
- **OKILAN 7130e Network Card (45268706)**  
The HSP Adaptor required to install this interface
- **HSP7130-ADP-ML4410 Adaptor (41139810)**  
For use with OKILAN 7130e Network Card only

## The OKI ML1190eco Dot Matrix Printer

**ML1190eco (EURO) 43516922**  
**ML1190eco (2AC) 01330001**

- 80 Column



- Top FEED  
Single cut-sheet paper
- Rear FEED  
Continuous paper
- Bottom FEED  
Continuous paper

### Applications Table

<b>Printing multi-part invoices, picking lists and receipts</b>	Printing on multi-part (up to 5 parts) paper to provide copies for picking lists, invoicing, record keeping and dispatch with goods. Using either bottom or rear feed, continuous forms tractor paper.
<b>Data recording and listings</b>	Reliable, accurate printing of data output from control and monitoring systems. On single or multipart continuous forms paper, using bottom or rear tractor feed.
<b>Printing pre-printed letter head paper &amp; forms</b>	Top feeding (friction feed) and printing of pre-printed forms or letters (single sheet or multi-part paper).
<b>Labels printing</b>	Rear feed possible with good quality labels. Bottom feed recommended for a straight paper path with the tractor in top position.

### ML1190

- **Easily accommodated in the smallest of spaces the ML1190 quickly delivers high quality multi-part documents with ease**
- **An efficient and cost effective light duty printing solution, perfect for many listing and point of sales applications**

- 24-Pin printer with a Graphics resolution up to 360 x 360dpi
- Maximum print speed of 333cps in High Speed Draft (10cpi)
- Fastest LQ print speed 83cps (10cpi)
- Small footprint (slightly larger than A4 paper) 150 x 349 x 232mm (HxWxD)
- Number of copies 5 (original plus 4 copies)
- Printer Emulations - Epson LQ, IBM PPR or IBM AGM
- Resident fonts: Utility, HSD, Courier (Scalable), Roman (Scalable), Swiss, Swiss Bold, Prestige, Gothic, Orator, OCR-A, OCR-B & Barcodes
- Auto paper load, paper park & low tear-off as standard
- Highly versatile paper handling - top friction and bottom/rear tractor feeds
- Interchangeable tractor unit – top position for bottom pull feed and rear position for rear push feed.
- First printable line (from top of page to centre of character) is 2.12mm for cut sheet and 2.12mm for continuous form paper
- USB, Parallel and RS232 interfaces as standard
- Ribbon Life 4 Million characters
- Robust 400 Million strokes per wire print head
- Mean Time Between Failures (MTBF) 10,000 hours

### Consumables

Product	Life in Characters	Order No.
Black Ribbon	4 Million	43571802

### Accessories

- **There are no accessories for this product**

## The OKI ML3390/1eco Dot Matrix Printer

**ML3390eco (EURO) 01308401**  
**ML3390eco (2AC) 01308403**

**ML3391eco (EURO) 01308501**  
**ML3391eco (2AC) 01308503**

- 80 Column

- 136 Column

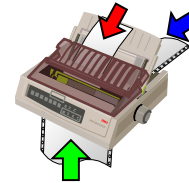

- Top FEED  
Single cut-sheet paper
- Rear FEED  
Continuous paper
- Bottom FEED  
Continuous paper



### Applications Table

<b>Printing pre-printed letter head paper, and forms</b>	Top feeding (friction feed) forms or individual sheets of letter headed paper (Single sheet or multi-part paper)
<b>Reports</b>	Either front or rear feed continuous paper for super fast overnight printing of reports
<b>Printing multi-part invoices, picking lists and receipts.</b>	Either bottom or rear feed multi-part paper up to 5 copies to provide picking lists, copies for dispatch with goods, invoicing and record keeping.
<b>Continuous feed label, ticket &amp; cheque printing</b>	Bottom feed for a straight paper path (prevent snagging) of pre-perforated ticket or label paper. Opt. tractor unit required.
<b>Passenger lists or call logs (Normally ML3390eco only)</b>	Continuous roll paper can be friction feed through the printer and torn to length. Opt. Roll Paper Stand required

### ML3390/1eco

- **Fast, reliable and eco-friendly 24-pin printers that deliver real value for money**
- **They are fast, reliable and easy to use with a comprehensive range of fonts and barcode as standard they are perfect for printing dispatch notes, invoices and statements at the highest quality.**

- 24-Pin printer with a graphics resolution up to 360 x 360dpi
- Eco-friendly technology saves energy, "Sleep mode" consumes just 1.5W
- Maximum print speed of 390cps (15cpi) in utility
- Fastest LQ print speed 104/87cps (12/10cpi)
- Carriage widths 80 or 136 columns at 10cpi
- Number of copies 5 (original plus 4 copies)
- Printer Emulation Epson LQ Esc/P2, IBM ProPrinter X24/XL24
- Resident fonts: Utility, Courier (Scalable), Roman (Scalable), Swiss (Scalable), Prestige, Gothic, Swiss Bold, Orator, OCR-A, OCR-B & Barcodes
- Auto paper load, paper park, rear push tractor & low tear-off
- Highly versatile top, bottom and rear paper feeds
- First printable line (from top of page) is 0.5mm for both cut sheet paper and continuous form paper
- USB and Parallel interfaces as standard
- Optional Network and RS232 interfaces
- Robust 200 Million character print head
- Mean Time Between Failures (MTBF) 10,000 hours

### Consumables

Product	Life in Characters	Order No.
Black Ribbon	2 Million	09002309

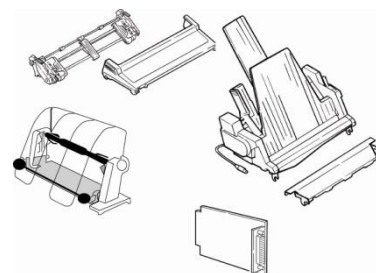

### Accessories

- **RS232 Serial Interface (44455102)** connections up to 15m
- **OKILAN 7130e Network Card (45268706)**
- **Pull Tractor – ML3390eco (09002365)**
- **Pull Tractor – ML3391eco (09002369)**  
Top mounted for bottom feeding of continuous paper from 76.2 to 254mm (or 406.5mm on the ML3321eco) wide
- **Push Tractor – ML3920eco (09002366)**
- **Push Tractor – ML3921eco (09002370)**  
Front or Rear mounted for push feeding of continuous paper from 76.2 to 254mm (or 406.5mm on the ML3321eco) wide
- **Single Bin Cut Sheet Feeder – ML3390eco (44497402)**
- **Single Bin Cut Sheet Feeder – ML3391eco (44497502)**  
For automatic feeding of multiple single sheets of paper from 76.2 to 254mm (or 406.5mm on ML3391eco) wide
- **Roll Paper Stand (09002332)**  
For feeding continuous rolls from 214 to 216mm wide and up to 128mm in diameter (Core diameter 25mm)

## The OKI ML5590/1eco Dot Matrix Printer

**ML5590eco (EURO) 01308801**  
**ML5590eco (2AC) 01308803**

- 80 Column



**ML5591eco (EURO) 01308901**  
**ML5591eco (2AC) 01308903**

- 136 Column

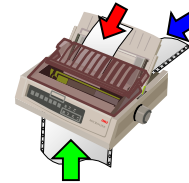

- **Top FEED**  
Single cut-sheet paper
- **Rear FEED**  
Continuous paper
- **Bottom FEED**  
Continuous paper



### Applications Table

<b>Printing pre-printed letter head paper, and forms</b>	Top feeding (friction feed) forms or individual sheets of letter headed paper (Single sheet or multi-part paper)
<b>Reports</b>	Either front or rear feed continuous paper for super fast overnight printing of reports
<b>Printing multi-part invoices, picking lists and receipts.</b>	Either bottom or rear feed multi-part paper up to 6 copies to provide picking lists, copies for dispatch with goods, invoicing and record keeping.
<b>Continuous feed label, ticket &amp; cheque printing</b>	Bottom feed for a straight paper path (prevent snagging) of pre-perforated ticket or label paper. Opt. tractor unit required.
<b>Passenger lists or call logs (Normally ML5590eco only)</b>	Continuous roll paper can be friction feed through the printer and torn to length. Opt. Roll Paper Stand required

### ML5590/1eco

- **Fast, environmentally friendly 24-pin printers that handle high print volumes with ease**
- **Superb print quality, robust construction and a fast throughput make these printers perfect for printing invoices, picking lists, spread-sheets, labels and barcodes.**
- 24-Pin printer with a graphics resolution up to 360 x 360dpi
- Eco-friendly technology saves energy, "Sleep mode" consumes just 1.5W
- Maximum print speed of 420cps (12cpi) in super speed draft
- Fastest LQ print speed 126/105cps (12/10cpi)
- Carriage widths 80 or 136 columns at 10cpi
- Number of copies 5 (original plus 4 copies)
- Printer Emulation Epson LQ, IBM ProPrinter III/AGM
- Resident fonts: Utility, HSD, Courier (Scalable), Roman (Scalable), Swiss (Scalable), Prestige, Gothic, Swiss Bold, Orator, OCR-A, OCR-B & Barcodes
- Auto paper load, paper park, rear push tractor & low tear-off
- Highly versatile top, bottom and rear paper feeds
- First printable line (from top of page) is 0.5mm for both cut sheet paper and continuous form paper
- USB and Parallel interfaces as standard
- Optional Network and RS232 interfaces
- Robust 200 Million character print head
- Mean Time Between Failures (MTBF) 20,000 hours

### Consumables

Product	Life in Characters	Order No.
Black Ribbon	4 Million	01126301

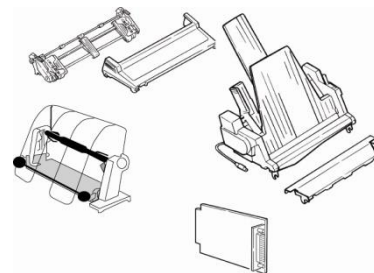

### Accessories

- **RS232 Serial Interface (44455102)** connections up to 15m
- **OKILAN 7130e Network Card (45268706)**
- **Pull Tractor – ML5520eco (09002365)**
- **Pull Tractor – ML5521eco (09002369)**  
Top mounted for bottom feeding of continuous paper from 76.2 to 254mm (or 406.5mm on the ML5521eco) wide
- **Push Tractor – ML5520eco (09002366)**
- **Push Tractor – ML5521eco (09002370)**  
Front or Rear mounted for push feeding of continuous paper from 76.2 to 254mm (or 406.5mm on the ML5521eco) wide
- **Single Bin Cut Sheet Feeder – ML5520eco (44497402)**
- **Single Bin Cut Sheet Feeder – ML5521eco (44497502)**  
For automatic feeding of multiple single sheets of paper from 76.2 to 254mm (or 406.5mm on ML5521) wide
- **Roll Paper Stand (09002332)**  
For feeding continuous rolls from 214 to 216mm wide and up to 128mm in diameter (Core diameter 25mm)

## The OKI ML5790/1eco Dot Matrix Printer

**ML5790eco (EURO) 44210105**  
**ML5790eco (2AC) 01293101**

**ML5791eco (EURO) 44210205**  
**ML5791eco (2AC) 01293201**

- 80 Column



- 136 Column

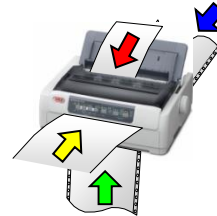

- Top friction FEED  
Single cut-sheet paper
- Rear tractor push FEED  
Continuous paper
- Bottom pull tractor FEED  
Continuous paper
- Front FEED  
Friction feeding Single cut-sheet paper or push feeding continuous paper



### Applications Table

<b>Printing pre-printed letter head paper and forms</b>	Top feeding (friction feed) forms or individual sheets of letter headed paper. (single sheet or multi-part paper)
<b>Reports</b>	Either front or rear feed continuous paper for super fast overnight printing of reports.
<b>Printing multi-part invoices, picking lists and receipts</b>	Either front or rear feed multi-part paper up to 6 copies to provide picking lists, copies for dispatch with goods, invoicing and record keeping.
<b>Continuous feed label, ticket &amp; cheque printing</b>	Bottom feed for a straight paper path to prevent snagging of pre-perforated ticket or label paper (optional Pull Tractor required).
<b>Passenger or data lists and call logs (ML5790eco only)</b>	Continuous roll paper can be friction feed through the printer and torn to length (optional Roll Paper Stand required).

### ML5790/1eco

- **High duty, high quality 24-pin dot matrix printers with truly versatile paper handling, low running costs and low energy usage.**
- **Scalable fonts and high print quality improve the presentation of multi-part documents making these printers perfect for printing receipts, invoices, dispatch notes and spreadsheets.**
- 24-Pin printer with a graphics resolution up to 360 x 360dpi
- Maximum print speed of 576cps (12cpi) in High Speed Draft
- Letter Quality (LQ) print speed 144/120cps (12/10cpi)
- Carriage widths 80 or 136 columns at 10cpi
- Maximum number of copies up to 6 parts
- Printer Emulation Epson LQ ESC/P2, IBM AGM/ProPrinter
- Resident fonts: Draft, HSD, Courier (Scalable), Roman (Scalable), Swiss (Scalable), Prestige, Gothic, Swiss Bold, Orator, OCR-A, OCR-B & Barcodes
- Auto paper load, paper park & low tear-off as standard
- Versatile top (friction), front (friction/tractor) bottom & rear feed (tractor)
- Interchangeable tractor unit – front push or rear push positions.
- First printable line (from top of page) is 0.5mm for cut sheet paper and 2.12mm for continuous form paper
- USB/Parallel interfaces as standard - Optional Network & RS232 interfaces
- Robust 400 Million character print head
- Mean Time Between Failures (MTBF) 25,000 hours
- Low power consumption 52W Letter Roman printing and 1.5W Sleep mode

### Consumables

Product	Life in Characters	Order No.
ML5790eco Black Ribbon	8 Million	44173405
ML5791eco Black Ribbon	13 Million	44173406

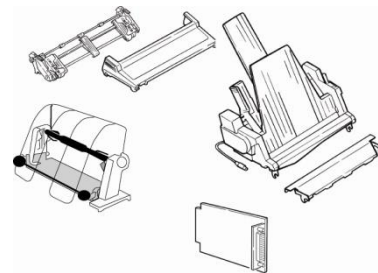

### Accessories

- **RS232 Serial Interface (44455102)** connections up to 15m
- **OKILAN 7130e Network Card (45268706)**
- **Pull Tractor – ML5790eco (44753902)**
- **Pull Tractor – ML5791eco (44754002)**  
Top mounted for bottom feeding of continuous paper from 76.2 to 254mm (or 406.5mm on the ML5721) wide
- **Push Tractor – ML5790eco (44454902)**
- **Push Tractor – ML5791eco (44455002)**  
Front or Rear mounted for push feeding of continuous paper from 76.2 to 254mm (or 406.5mm on the ML5721) wide
- **Single Bin Cut Sheet Feeder – ML5790eco (44497402)**
- **Single Bin Cut Sheet Feeder – ML5791eco (44497502)**  
For automatic feeding of multiple single sheets of paper from 76.2 to 254mm (or 406.5mm on ML5791) wide
- **Roll Paper Stand – ML5790eco only (09002332)**  
For feeding continuous rolls from 214 to 216mm wide and up to 128mm in diameter (Core diameter 25mm)

## The OKI ML395 Dot Matrix Printer

**ML395B (MULTI) 00035719**

- 136 Column



- Top FEED  
Single cut-sheet paper
- Rear FEED  
Continuous paper
- Bottom FEED  
Continuous paper

### Applications Table

<b>Printing pre-printed letter head paper and forms</b>	Top feeding (friction feed) of pre-printed forms or individual sheets of letter headed paper (single sheet or multi-part paper)
<b>Reports</b>	Either front or rear feed continuous paper for super fast overnight printing of reports
<b>Printing multi-part invoices, picking lists, shipping &amp; export documents.</b>	Either bottom or rear feed multi-part paper up to 8 copies to provide picking lists, copies for dispatch with goods, invoicing and record keeping.
<b>Continuous feed ticket &amp; cheque printing</b>	Bottom feed for a straight paper path (prevent snagging) of pre-perforated ticket or label paper. Opt. tractor unit required.
<b>Continuous feed label printing</b>	Bottom feed for a straight paper path (prevent peeling) of pre cut labels using a top pull tractor or bottom power tractor

### ML395B

- **A Heavy Duty 24-pin printer that's powerful, fast and very robust the ML395 is built to handle the most data-intensive applications**
- **Powerful motors a robust construction and heavy duty 24-pin print head make it perfect for printing large volumes of invoices, picking lists, shipping notes, export documents with superb print quality.**

- 24-Pin printer with a graphics resolution up to 240 x 360dpi
- Maximum print speed of 607cps (15cpi) in high speed draft
- Fastest LQ print speed 162/135cps (12/10cpi)
- Carriage width is 136 columns at 10cpi
- Number of copies 4 (original plus 3 copies)
- Printer emulations: Epson LQ, IBM ProPrinter X24E/X24E AGM
- Resident fonts: Utility, HSD, Courier, Roman, Swiss, Prestige, Gothic, Swiss Bold & Barcodes
- Auto paper load, paper park, rear push tractor & zero tear-off
- Highly versatile top, bottom and rear paper feeds (Power push tractor Opt)
- First printable line (from top of page) is 2.12mm for cut sheet and continuous form paper
- Parallel and RS232 interfaces as standard
- Optional pull tractor & bottom power push tractor for feeding heavy paper
- Robust 200 Million character print head
- Mean Time Between Failures (MTBF) 8,000 hours

### Consumables

Product	Life in Characters	Order No.
Black Ribbon	5 Million	09002311



### Accessories

- **Pull Tractor (09002377)**  
Feeding continuous paper from 76.2 to 406.5mm wide
- **Bottom Power Push Tractor (09002378)**  
Power feeding continuous paper from 76.2 to 406.5mm wide
- **Single Bin Cut Sheet Feeder (09000705)**  
Feeding single sheet paper from 76.2 to 406.5mm wide

## The OKI ML5100FB eco Dot Matrix Printer

**ML5100FB eco (EURO) 437182217**  
**ML5100FB eco (2AC) 01330101**

- 80 Column



➔ Front in Front out FEED  
Single cut-sheet paper

➔ Rear in Front out FEED  
Continuous paper

**Perfect for customer facing environments:**

- Banks
- Travel agents
- Chemists
- Airports
- Doctors surgeries

### Applications Table

<b>Printing pre-printed letter head paper and forms</b>	Front friction feeding of pre-printed forms or individual sheets of letter headed paper (single sheet or multi-part paper)
<b>Reports and listings</b>	Rear feed continuous paper for fast printing of reports or listings
<b>Printing multi-part invoices, picking lists, dispatch notes &amp; receipts.</b>	Rear feed multi-part paper up to 5 copies to provide picking lists, copies for dispatch with goods, invoicing and record keeping.
<b>Slip printing of ticket, cheques, index cards &amp; appointment cards</b>	Front in, front out friction feed of various different sizes of paper. The flat paper path prevents snagging of pre-perforated ticket or label paper and allows printing on card.
<b>Continuous feed label printing</b>	Rear feed in, front out flat paper path feeding (prevent peeling) of pre cut labels

### ML5100FB eco

- **Reliable, flexible and great value for money 24-pin flatbed dot matrix printer.**
- **This compact flatbed printer with its front in, front out paper feed operation can work in awkward locations and customer service points where space is at a premium.**

- 24-Pin printer with a graphics resolution up to 360 x 360dpi
- Maximum print speed of 375cps (15cpi) in utility
- Fastest LQ print speed 85cps (10cpi)
- Carriage width is 80 columns at 10cpi
- Number of copies 5 (original plus 4 copies)
- Printer emulations: Epson LQ, IBM ProPrinter/AGM
- Resident fonts: Utility, HSD, Courier, Roman, Swiss, Prestige, Gothic, Swiss Bold, Orator, OCR-A, OCR-B
- Auto paper load, paper park, rear push tractor & low tear-off
- Highly versatile front friction feed & rear tractor feeds (single or multi-part)
- First printable line (from top of page) is 2.12mm for cut sheets and continuous form paper
- USB 2.0, Parallel and RS232C interfaces as standard
- Robust 200 Million character print head
- Mean Time Between Failures (MTBF) 10,000 hours
- Low power consumption 45W ISO/IEC 10561 Letter and 1.7W Sleep mode

### Consumables

Product	Life in Characters	Order No.
Black Ribbon	4 Million	43821103

### Accessories

- **There are no accessories for this product**



## The OKI ML6300FB-SC Dot Matrix Printer

ML6300FB-SC (EURO) 43490003  
ML6300FB-SC (2AC) 01265001

- 106 Column

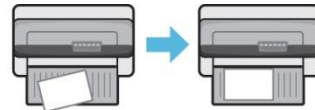

Automatically corrects paper skew

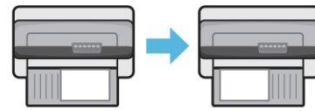

Paper can be loaded from any position for the same printing result

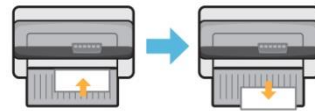

Printer can sense paper width and reject it if incorrect



➔ Front in Front out FEED  
➔ Front in Rear out FEED  
Single cut-sheet paper

➔ Rear in Front out FEED  
Continuous paper

Perfect for customer facing environments:

- Banks
- Travel agents
- Railway stations
- Airports
- Doctors surgeries



### Applications Table

<b>Printing pre-printed letter head paper and forms</b>	Front friction feeding of pre-printed forms or individual sheets of letter headed paper (single sheet or multi-part paper)
<b>Reports and listings</b>	Rear feed continuous paper for fast printing of reports or listings
<b>Printing multi-part invoices, picking lists, dispatch notes &amp; receipts.</b>	Rear feed multi-part paper up to 6 copies to provide picking lists, copies for dispatch with goods, invoicing and record keeping.
<b>Slip printing of ticket, cheques, index cards &amp; appointment cards</b>	Front in, front out friction feed of various different sizes of paper. The flat paper path prevents snagging of pre-perforated ticket or label paper and allows printing on card.
<b>Continuous feed label printing</b>	Rear feed in, front out flat paper path feeding (prevent peeling) of pre cut labels

### ML6300FB-SC

- **Get error free paper handling as standard with the ML6300FB-SC.**
- **The flatbed design of this high performance 24-pin dot matrix printer boasts powerful features such as automatic skew correction, paper width detection and location-free paper loading to save time, paper wastage and make to life easy for the user.**

- 24-Pin printer with a graphics resolution up to 360 x 360dpi
- Maximum print speed of 450cps (15cpi) in utility
- Fastest LQ print speed 120/100cps (12/10cpi)
- Carriage width is 136 columns at 10cpi
- Number of copies 6 (original plus 5 copies)
- Printer emulations: Epson LQ, IBM ProPrinter/AGM
- Resident fonts: Utility, HSD, Courier, Roman, Swiss, Prestige, Gothic, Swiss Bold, Orator, OCR-A, OCR-B & Barcodes
- Auto paper load, paper park, rear push tractor & low tear-off
- Highly versatile front friction feed & rear tractor feeds (single or multi-part)
- First printable line (from top of page) is 2.12mm for cut sheets and continuous form paper
- Parallel and USB interfaces as standard
- Optional RS232 and network interfaces available
- Robust 200 Million character print head
- Mean Time Between Failures (MTBF) 12,000 hours

### Consumables

Product	Life in Characters	Order No.
Black Ribbon	4 Million	43503601

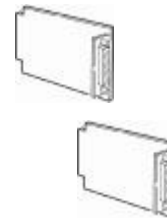

### Accessories

- **RS232 Serial Interface (09002351)** connections up to 15m
- **OKILAN 7130e Network Card (45268706)**